

RECOMMENDED PCB PATTERN LAYOUT
GENERAL TOLERANCE: ±0.05

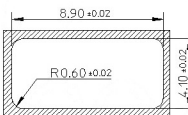

RECOMMENDED OPENING DIMENSIONS OF CASE
MATING AREA WITH SEALING RING

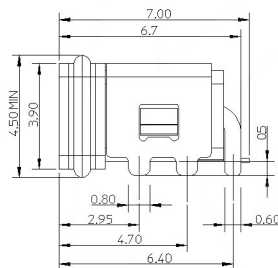
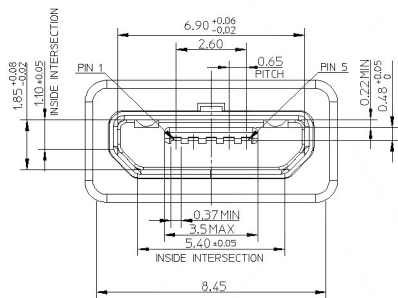
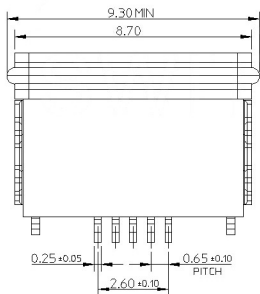

NOTES:

- MATERIAL:
HOUSING: LCP, BLACK, UL94V-0,
TERMINAL: COPPER ALLOY, THICKNESS: 0.15mm,
SHELL: STAINLESS STEEL, THICKNESS: 0.30mm,
METAL TAB: STAINLESS STEEL, THICKNESS: 0.25mm,
SEALING RING: SILICON RUBBER.
- PLATING:
TERMINAL: CONTACT AREA: GOLD FLASH OVER MINIMUM 0.75MICRON Pd/Ni,
SOLDER TAIL AREA: GOLD FLASH, UNDER PLATING: NICKEL 2.0MICRON MINIMUM.
SHELL / METAL TAB: 2.0MICRON MINIMUM MATTE TIN OVER
1.27MICRON MINIMUM NICKEL UNDER PLATING.
- TAIL COPLANARITY 0.08mm MAXIMUM.
- PRODUCT SPECIFICATION: PK-105296-002.
- PACKAGE SPECIFICATION: PS-105296-001.
- PRODUCTS MEET IP67 TEST REQUEST.
- COMPLIANT TO RoHS DIRECTIVE 2011/65/EU AND ELV 2000/53/EC.

						ANGULAR	±5°	
△ X						$L \leq 4$	±0.2	
△ X						$4 < L \leq 16$	±0.3	
△ X						$16 < L \leq 63$	±0.4	
MARK	DESCRIPTION	DATE	REVISED	APPROVED		$L > 63$	±0.5	
REVISIONS							UNSPECIFIED TOLERANCES	
www.bodongkaiguan.net www.ksdkg.com								

DSND		DATE		SCALE: N/A	MODEL TYPE:	
DWN		DATE		VIEW:	MICRO USB	
CHKD		DATE		UNIT: mm	PART NO.:	
APPD		DATE		SIZE: A4	DWG NO.:	
					U-E-M5SS-Y-6	
				WEIGHT	SHEET	REVISION
				1.0g	1/1	A0

KOSOD TECHNOLOGY CO., LTD