

Circuit Diagram

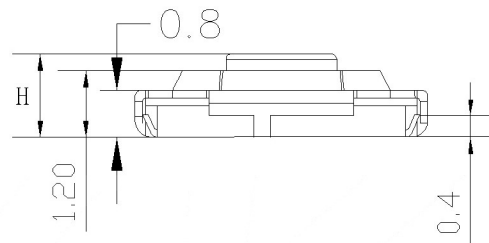

P.C.B. Layout

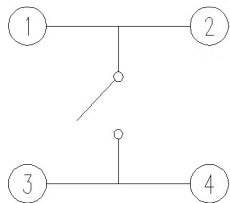
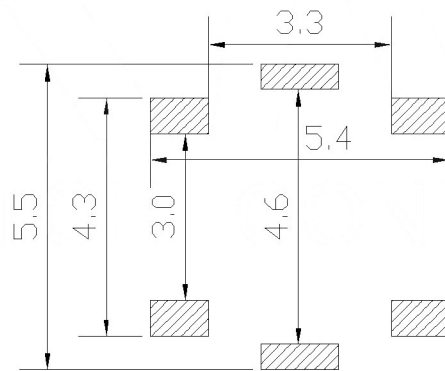

Code-X	H
A	1.5
B	1.6
C	1.7
D	2.0
E	2.5
F	3.0
G	3.5
H	4.0
I	4.3
J	4.5
K	5.0

SPECIFICATION

Contact Rating: 50mA, 12V DC
 Contact Resistance: 100mΩ max
 Insulation Resistance: 100mΩ min. 500V DC
 Dielectric Strength: 250V AC/1minute
 Travel: 0.25mm
 Operating Temp: -30℃~+85℃
 Storage Temp: -30℃~+80℃

PAPT NO	TS-1187E-X-X-X
Operating Force	A: 100gf B: 160gf C: 260gf
Height	Code-X
Keystake	A: PA16 B: Brass

ITEM	PAPT NAMF	TER,NO	QTY	MATERIAL	FINISHING	REMARK
⑤	Terminal	—	4	Brass (0.30t)	Plating silvering	—
④	Contact	—	1	F.ag/Sus	Natural	—
③	Base	—	1	Lcp	—	—
②	Cover	—	1	Brass	Plating Nickel	—
①	Keystake	—	1	Brass	—	—

MARK	DESCRIPTION	DATE	REVISED	APPROVED	UNSPECIFIED TOLERANCES	DSND	DATE	SCALE: N/A	MODEL TYPE:		
ΔX					units: mm	DWN	DATE	VIEW:	TACT SWITCH		
ΔX					tolerance:	CHKD	DATE	UNIT: mm	PART NO.:		
ΔX					X.X ±0.2mm	APPD	DATE	SIZE: A4	DWG NO.:		
					X.XX ±0.1mm				TS-1187E-X-X-X		
					X.XXX ±0.05mm				WEIGHT	SHEET	REVISION
									1.0g	1/1	A0