

P. C. B LAYOUT

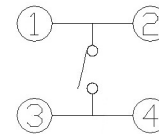

SCHEMATIC

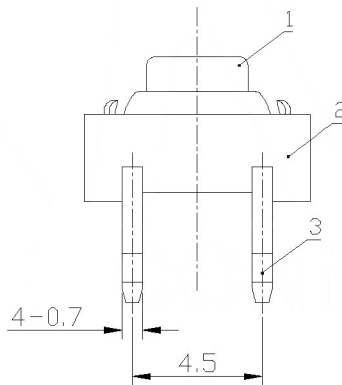
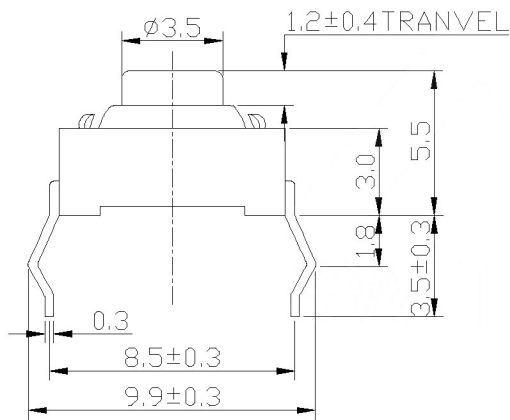

SPECIFICATION

Contact Rating : 50mA, 12V DC
 Contact Resistance : 100m Ω max
 Insulation Resistance : 100m Ω min.500V DC
 Dielectric Strength : 250V AC/1minute
 Travel : 1.2mm
 Operating Temp : -30 $^{\circ}$ C ~ +85 $^{\circ}$ C
 Storage Temp : -30 $^{\circ}$ C ~ +80 $^{\circ}$ C

PAPT NO	TC-1117-X
Operating Force	B: 120gf
Height	II: 5.5

ITEM	PAPT NAMF	TER.NO	QTY	MATERIAL	FINISHING	REMARK
③	Terminal	4	4	Brass (0.30t)	Plating silvering	
②	Base	1	1	Pa46		
①	Keystake	1	1	Silica gel		

MARK	DESCRIPTION	DATE	REVISED	APPROVED	UNSPECIFIED TOLERANCES	DSND	DATE	SCALE: N/A	MODEL TYPE: TACT SWITCH
Δ X					units: mm	DWN	DATE	VIEW:	PART NO.:
Δ X					tolerance:	CHKD	DATE	UNIT: mm	DWG NO.:
Δ X					X.X ± 0.2 mm	APPD	DATE	SIZE: A4	TC-1117-X
					X.XX ± 0.1 mm				WEIGHT
					X.XXX ± 0.05 mm				1.0g
									SHEET
									1/1
									REVISION
									A0