

CIRCUIT DIAGRAM

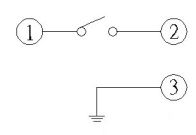

P.C.B LAYOUT MOUNTING PATTERN

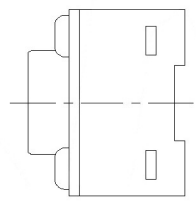
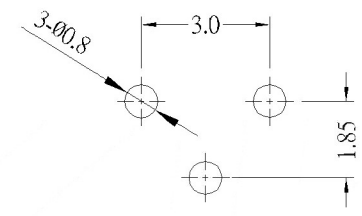

SPECIFICATION

Contact Rating : 50mA,12V DC
 Contact Resistance : 100mΩ max
 Insulation Resistance : 100mΩ min.500V DC
 Dielectric Strength : 250V AC/1minute
 Travel : 0.25mm
 Operating Temp : -30℃~+85℃
 Storage Temp : -30℃~+80℃

Code-X	H
A	3.8
B	4.3
C	4.5
D	5.0
E	5.5
F	6.0
G	6.5
H	7.0
I	7.5
J	8.0
K	8.5
L	9.0

PAPT NO	TC-1109DE-X-X
Operating Force	A: 100gf B: 160gf C: 260gf
Height	Code-X

ITEM	PAPT NAMF	TER.NO	QTY	MATERIAL	FINISHING	REMARK
⑤	Terminal	---	3	Brass (0.30t)	Plating silvering	---
④	Contact	---	1	F.ag/Sus	Natural	---
③	Base	---	1	Pa46	---	---
②	Cover	---	1	Sppc	Plating Nickel	---
①	Keystone	---	1	Pa46	---	---

MARK	DESCRIPTION	DATE	REVISED	APPROVED	UNSPECIFIED TOLERANCES	DSND	DATE	SCALE: N/A	MODEL TYPE: TACT SWITCH		
ΔX					units: mm	DWN	DATE	VIEW:	PART NO.:		
ΔX					tolerance:	CHKD	DATE	UNIT: mm	DWG NO.:		
ΔX					X.X ±0.2mm	APPD	DATE	SIZE: A4	TC-1109DE-X-X		
					X.XX ±0.1mm				WEIGHT	SHEET	REVISION
					X.XXX ±0.05mm				1.0g	1/1	A0