

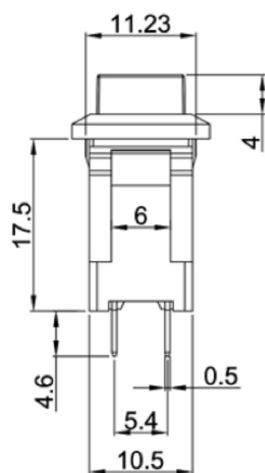

Rating : 3A 125VAC
 : 1A 250VAC
 Contact Resistance :30mΩ Max.
 Insulation Resistance :DC 500V 100MΩ Min.
 Dielectric Strength :AC 1000V 1 minute
 Total travel :3±0.5mm
 Operating Force :450±100gf
 Electrical Life :Over 10,000 cycles
 Mechanical Life :Over 30,000 cycles
 Cap Pull Test :≥ 2kgf for 1 minute
 Back Cover Buckle Pull Test :≥ 3kgf for 1 minute
 Carle Thrust Test :≥ 3kgf for 1 minute
 Terminal strength :≥ 5kgf for 1 minute
 Operating Temperature :-20°C~+85°C
 Soldering Temperature : 256°C for 5 Seconds
 Function : OFF-ON
 Welding method : Manual Soldering
 (350° C±5° C,3s±0.5s)

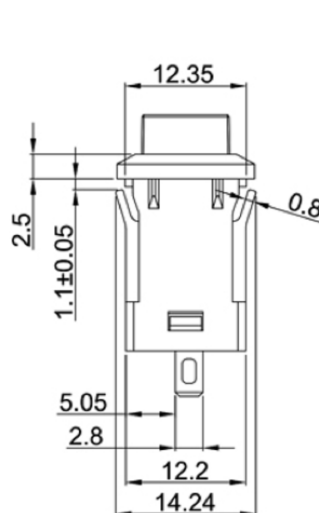

FUNCTION

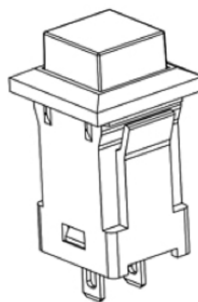
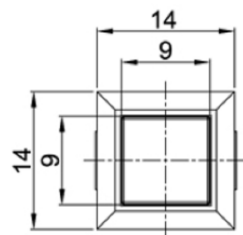
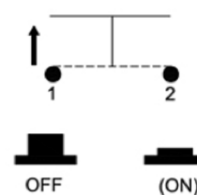

2P SPST

CUT-OUT

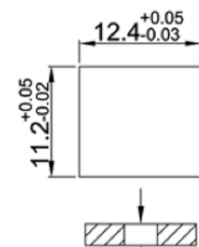

Panel Thickness: 1.0±0.03mm .

Y	Yellow	黄色
W	White	白色
U	Blue	蓝色
R	Red	红色
G	Green	绿色
B	Black	黑色
A	Gray	灰色
CAP COLOR(X)		

广东科斯达电子科技有限公司
 GUANG DONG KE SI DA ELECTRONIC TECHNOLOGY CO., LTD.

TOLERANCE UNLESS OTHERWISE STATED :
 Up to 5 ±0.2
 Above 5 ~ 15 ±0.3
 Above 15 ~ 30 ±0.4
 Above 30 ~ 50 ±0.5
 Angle ±0.3



UNITS MM

DRAWN BY:	DATE	MAT'L	TITLE	SWITCH
Jack Lu	12/27/22			
CHECKED BY:	DATE	FINISH	MODLE	TACT SWITCH WITH LED
Jacky Chen	12/27/22			
APPROVED BY:	DATE	SCALE	DWG NO.	SIZE
Tony Kao	12/27/22	1 : 1		A4
		SHEET NO.	PART NO.	VER
		1 of 1		R

ITEM NO.	DESCRIPTION	DRAWN	DATE