

SECT B-B

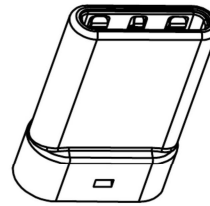

U261-24XXN-4B0400

1: Au
2: Ni
1:Au1u"
2:Au3u"
4:Au15u"
5:Au30u"

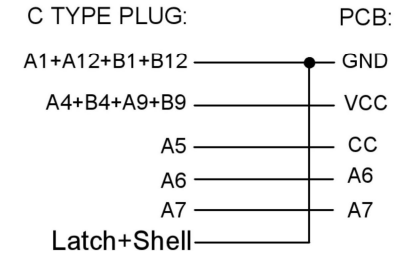

P/N	备注
U261-24XXN-4B0400	胶套本色 端子G/F 外壳镀金

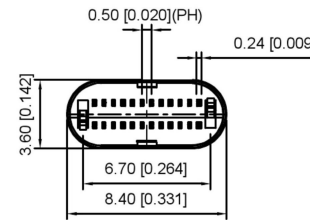
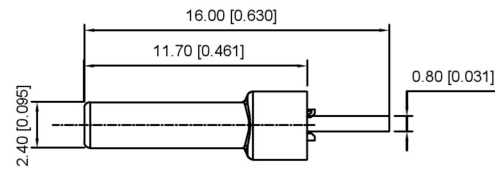

REMARKS:

- CONTACT INSERTION AND WITHDRAW FORCE :
 - Insertion force: 5N-20N max.
 - Withdrawal force: 8N-20N.
 - Durability : 10000Cycles.
- ELECTRIC PROPERTY :
 - Contact current rating: 3A.
 - Dielectric Strength: 100V AC(RMS).
 - Insulation Resistance: 100 megaohms min.
 - Contact resistance:
 - 40mohms MAX. FOR VBUS, GND AND OTHER CONTACT
 - 50mohms MAX. AFTER ENVIRONMENT TEST
- AMBIENT TEMPERATURE :
 - Operating temperature: -55°C to +85°C.

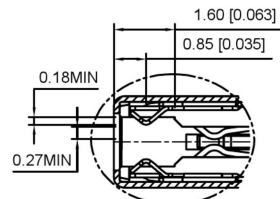
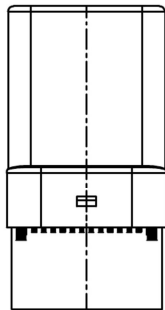
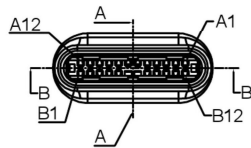

D
2:1

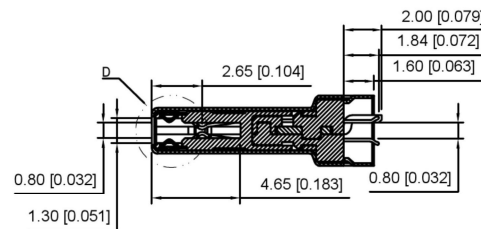

SECT A-A

A12	A11	A10	A9	A8	A7	A6	A5	A4	A3	A2	A1
GND	RX2+	RX2-	Vbus	SBU1	D-	D+	CC	Vbus	TX1-	TX1+	GND
GND	TX2+	TX2-	Vbus	Vconn			SBU2	Vbus	RX1-	RX1+	GND
B1	B2	B3	B4	B5	B6	B7	B8	B9	B10	B11	B12

ITEM	DESCRIPTION	MATERIAL	REMARKS
6	Shrapnel	SUS T=0.10mm	
5	Shell	SUS T=0.15mm	Ovep-plating : Ni 80U"MIN
4	Terminal	C7025 T=0.15mm	Ovep-plating:Au Ni/Sn
3	Latch	SUS T=0.4mm	
2	Housing	LCP	UL94-0
1	Housing Stopper	LCP	UL94-0

REVISIONS				DATE	REVISED	APPROVED	UNSPECIFIED TOLERANCES	DSND	SCALE: N/A	MODEL TYPE: Type-C 3.1
						ANGULAR ±5°		DWN	VIEW:	PART NO.:
						L ≤ 4 ±0.2		CHKD	UNIT: mm/in	DWG NO.:
						4 < L ≤ 16 ±0.3		APPD	SIZE: A4	U261-24XXN-4B0400
						16 < L ≤ 63 ±0.4		KE SI DA ELECTRONIC TECHNOLOGY CO., LTD		
						L > 63 ±0.5		WEIGHT SHEET REVISION		
WWW.BODONGKAIGUAN.NET WWW.CKJACK.COM WWW.KSDKG.COM								1/1 A0		