

SECT B-B

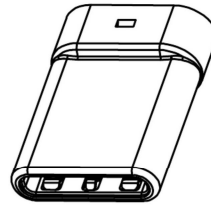

U261-24XXN-4B0417

C TYPE PLUG:

PCB:

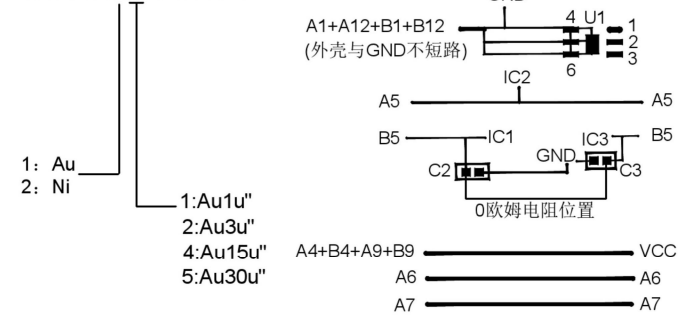

P/N	R/C
U261-24XXN-4B0417	在C2与C3靠近IC的位置竖着贴一个(0欧姆电阻)

REMARKS:

- CONTACT INSERTION AND WITHDRAW FORCE :
  - Insertion force: 5N-20N max.
  - Withdrawal force: 8N-20N.
  - Durability : 10000Cycles.
- ELECTRIC PROPERTY :
  - Contact current rating: 3A.
  - Dielectric Strength: 100V AC(RMS).
  - Insulation Resistance: 100 megaohms min.
  - Contact resistance : 40m0hms MAX.FOR VBUS,GND AND OTHER CONTACT 50m0hms MAX.AFTER ENVIRONMENT TEST
- AMBIENT TEMPERATURE :
  - Operating temperature: -55°C to +85°C.

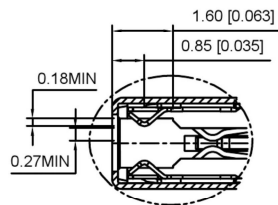
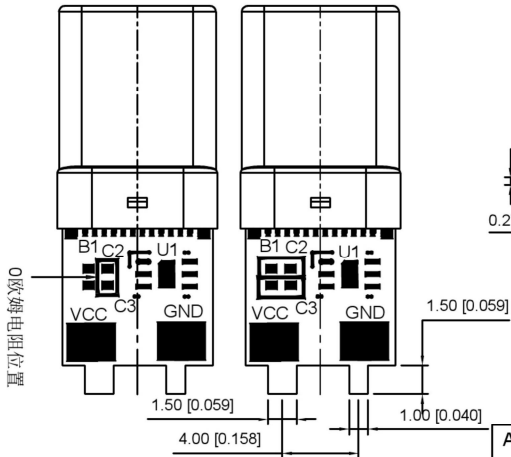
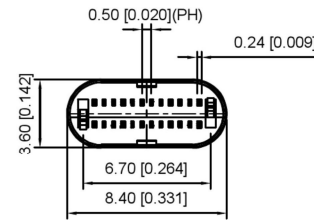
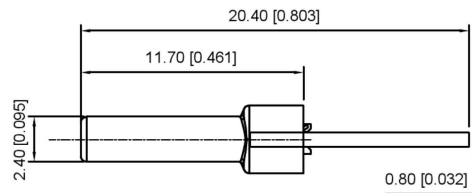
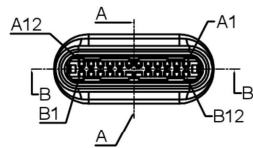

D  
2:1

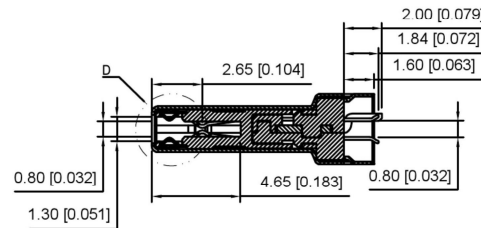

SECT A-A

A12	A11	A10	A9	A8	A7	A6	A5	A4	A3	A2	A1
GND	RX2+	RX2-	Vbus	SBU1	D-	D+	CC	Vbus	TX1-	TX1+	GND
GND	TX2+	TX2-	Vbus	Vconn			SBU2	Vbus	RX1-	RX1+	GND
B1	B2	B3	B4	B5	B6	B7	B8	B9	B10	B11	B12

ITEM	DESCRIPTION	MATERIAL	REMARKS
6	Shrapnel	SUS T=0.10mm	
5	Shell	SUS T=0.15mm	Ovep-plating: Ni
4	Terminal	C7025 T=0.15mm	Ovep-plating: Au Ni/Sn
3	Latch	SUS T=0.4mm	
2	Housing	LCP	UL94-0
1	Housing Stopper	LCP	UL94-0

REVISIONS	DATE	REVISED	APPROVED	UNSPECIFIED TOLERANCES
				ANGULAR ±5°
				L ≤ 4 ±0.2
				4 < L ≤ 16 ±0.3
				16 < L ≤ 63 ±0.4
				L > 63 ±0.5

<p>SWITCH CONNECTOR</p>	DSND	SCALE: N/A	MODEL TYPE: Type-C 3.1
	DWN	VIEW:	PART NO.:
	CHKD	UNIT: mm/in	DWG NO.:
	APPD	SIZE: A4	U261-24XXN-4B0417
KE SI DA ELECTRONIC TECHNOLOGY CO., LTD			WEIGHT SHEET REVISION
			1/1 A0