

# U261-12XN-4BS2S

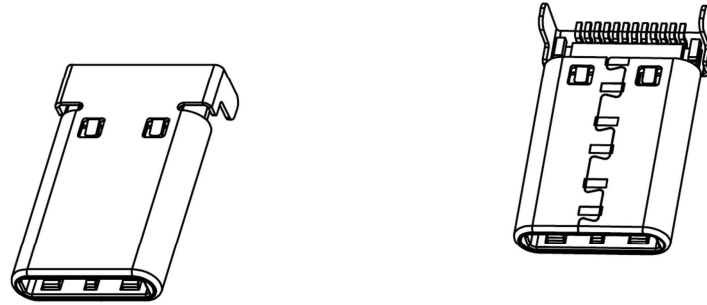

1: Au 1U" MIN  
2: Au 15U" MIN  
3: Au 30U" MIN

1:WITH  
2:WITHOUT  
B:BLACK  
U:BLUE  
W:WHITE  
C:CREAM-COLOR  
1:PBT  
2:PA6T  
3:PA9T  
4:LCP

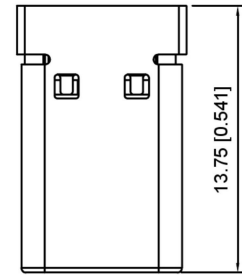
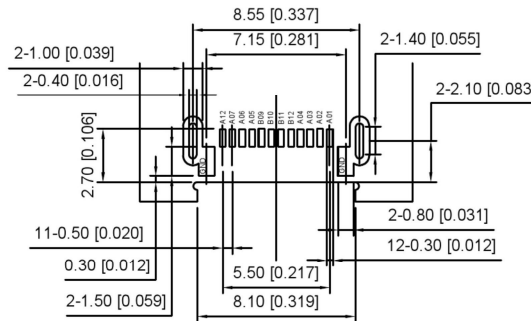
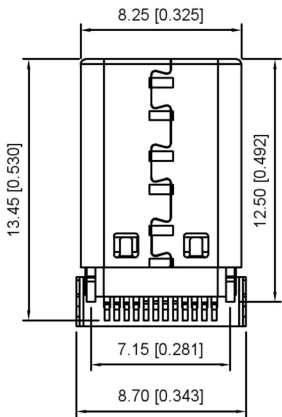
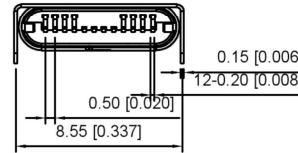
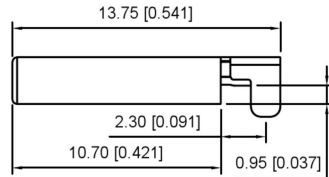
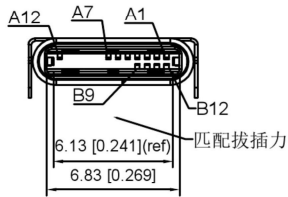

Recommended top mount P.C.B Layout  
Tolerance ±0.05

### NOTES:

1. UNLESS OTHERWISE SPECIFIED, ALL TOLERANCES FOLLOW DRAWING COMMON STANDARD.

### 2. Material:

Contacts: Copper Alloy, Thickness = 0.15±0.01mm.  
HOUSING: LCP+ 30% G.F, UL94V-0 COLOR: BLACK  
Shell: STEEL ALLOY, THICKNESS = 0.20±0.01mm  
SHIELD CONTACT: STEEL ALLOY, THICKNESS = 0.40±0.01mm

### 3. Electrical:

Current-max[amps]: 5A Max For Vbus/GND PIN;  
0.9A Max For Other PIN.

Withstanding Voltage: 100V AC R.M.S

Contact Resistance [ohms]: 40mΩ Max.For  
Initial 10mΩ.Change After

Test.Measure AT 20mV,100mA

Insulation Resistance [ohms]: 100 mΩ min.

### 4. MECHANICAL CHARACTERISTICS:

Mating force: 5~20N

Unmated Force: 8~20N After test.

Durability: 10000 cycles min.

### 5. Plating:

Contacts: SEE TABLE Au plated on contact area,  
Bright Tin plating 50U"Min on solder area

Nickel Under plating 50u"Min over all

Shell: plating 20~50U"Nickel over

### 6. Environmental

Temperature Range: -55°C~+85°C

### 7. LEAD-FREE AND ROHS COMPLIANT PRODUCT

4. ▼ SHOW CRITICAL DIMENSION.

				DSND	SCALE: N/A	MODEL TYPE: Type-C 3.1
				ANGLAR	DWN	PART NO.:
				±5°	VIEW:	DWG NO.:
				L ≤ 4	UNIT: mm/in	U261-12XN-4BS2S
				4 < L ≤ 16	SIZE: A4	WEIGHT
				16 < L ≤ 63		SHEET
				L > 63		REVISION
				±0.2		1/1
				±0.3		A0
				±0.4		
				±0.5		
REVISIONS				UNSPECIFIED TOLERANCES	KE SI DA ELECTRONIC TECHNOLOGY CO., LTD	
DATE	REVISED	APPROVED				
WWW.BODONGKAIGUAN.NET						
WWW.CKJACK.COM						
WWW.KSDKG.COM						