

Specifications:
 Operating Voltage:250V AC/DC
 Current Rating:3A AC/DC
 Withstand Voltage:1000V AC/Minute
 Contact Resistance: $\leq 10m\Omega$
 Insulation resistance: $\geq 1000m\Omega$
 Operating Temperature: $-25^{\circ}C \sim +85^{\circ}C$
 Material:PA66 UL94V-0
 PIN Brass Tin-plated

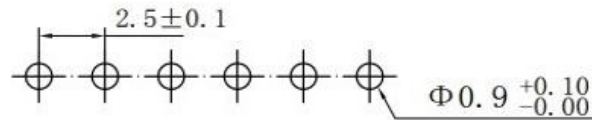
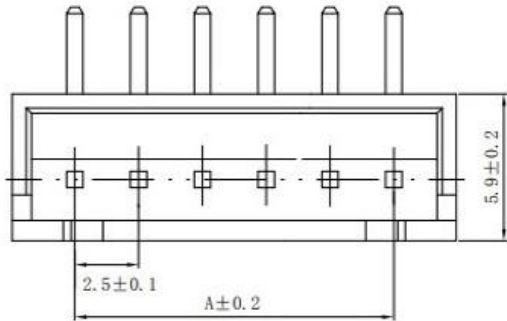
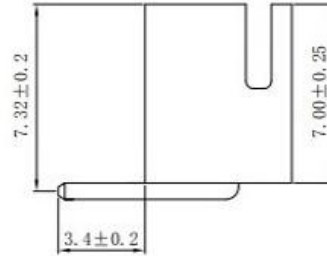
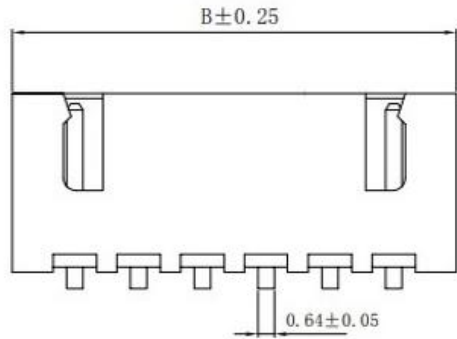

PCB LAYOUT

P数	尺寸 (mm)	
	A	B
2	2.5	7.5
3	5.0	10.0
4	7.5	12.5
5	10.0	15.0
6	12.5	17.5
7	15.0	20.0
8	17.5	22.5
9	20.0	25.0
10	22.5	27.5
11	25.0	30.0
12	27.5	32.5
13	30.0	35.0
14	32.5	37.5
15	35.0	40.0
16	37.5	42.5

科斯达电子科技有限公司

被檢尺寸標示 SYMBOLS \odot \ominus INDICATE CLASSIFICATION DIMENSION	工價 圖號	制圖 (DR) *10/02/22
\odot MARK IS CRITICAL DIM. \ominus MARK IS MAJOR DIM.	品名 弯针	審核 (CHKD)
表面處理 (FINISH)	TITLE XH2.5mm Pitch AW DIP CONN	核准 (APPD) Rigo Lu
比例 (SCALE) 1:1	單位 (UNITS) mm	張數 (SHEET) 1 OF 1
		SIZE A4
		REV 0

REV	DESCRIPTION	DATE	SIGNATURE
-	修改描述	-	-