

MATING HEIGHT
SCALE:1.25:1

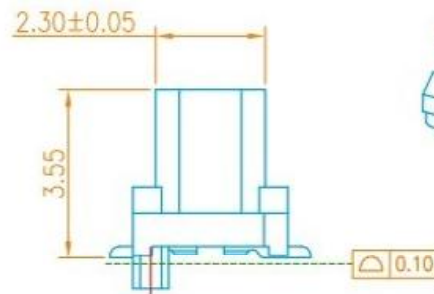

3D VIEW

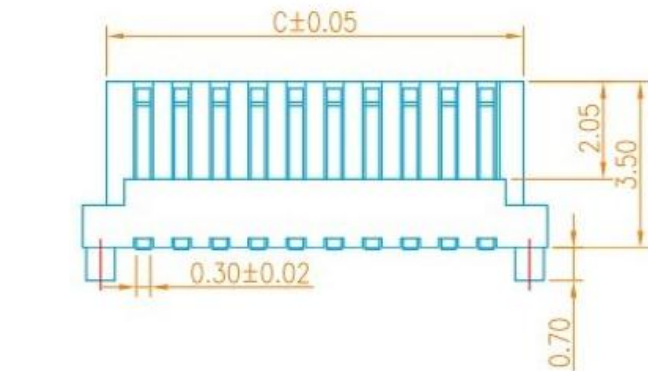
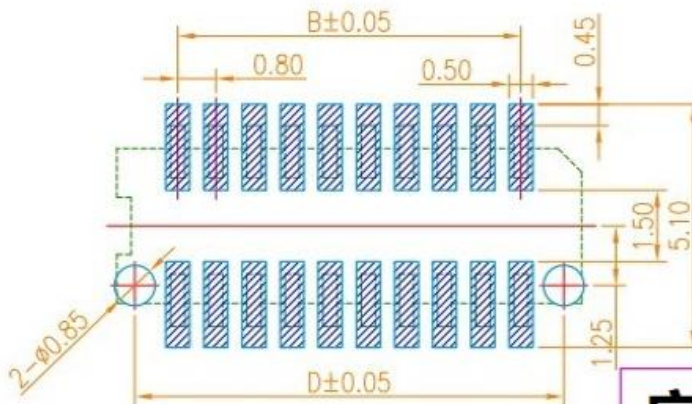
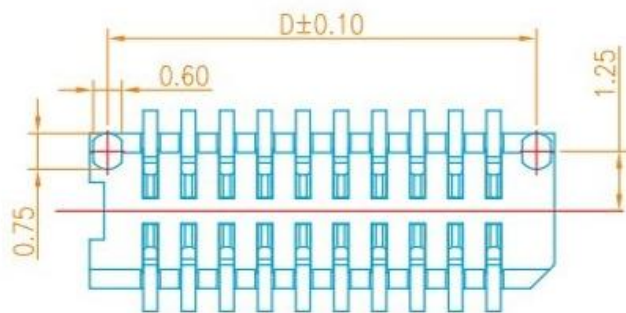

RECOMMENDED PCB PATTERN DIM.
TOLERANCE : ±0.05

NOTES:

- HUOSING: PA9T HIGH-TEMP THERMOPLASTIC UL94V-0 COLOR:CREAM-COLOURED
- TERMINAL:PHOSPHOR BRONZE
PLATING:1*GOLD FLASH OVERALL 50~100* NICKEL UNDER PLATED.

Ordering information

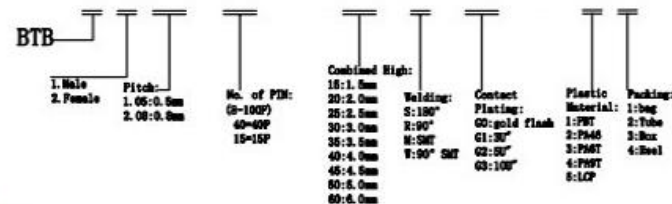

NO. of contacts	Dimensions			
	A.	B.	C.	D.
4	3.35	0.80	2.35	2.60
6	4.15	1.60	3.15	3.40
8	4.95	2.40	3.95	4.20
10	5.75	3.20	4.75	5.00
12	6.55	4.00	5.55	5.80
14	7.35	4.80	6.35	6.60
16	8.15	5.60	7.15	7.40
18	8.95	6.40	7.95	8.20
20	9.75	7.20	8.75	9.00
22	10.55	8.00	9.55	9.80
24	11.35	8.80	10.35	10.60
26	12.15	9.60	11.15	11.40
28	12.95	10.40	11.95	12.20
30	13.75	11.20	12.75	13.00
32	14.55	12.00	13.55	13.80
34	15.35	12.80	14.35	14.60
36	16.15	13.60	15.15	15.40
38	16.95	14.40	15.95	16.20
40	17.75	15.20	16.75	17.00
42	18.55	16.00	17.55	17.80
44	19.35	16.80	18.35	18.60
46	20.15	17.60	19.15	19.40
48	20.95	18.40	19.95	20.20
50	21.75	19.20	20.75	21.00
52	22.55	20.00	21.55	21.80

广东科斯达科技有限公司

一般公差 GENERAL TOLERANCE	Kevin 2016.07.05	品名(TITLE): BTB 0.8 2*NP SMT 侧插公座
审核 (REV):	料号 (PART NO):	比例 (SCALE):
版本 (REV): A	单位 (UNITS): mm	张数 (SHEET): 1 OF 1
图例 (APP):	图幅 (SIZE): A4	

修订 (REV)	修改摘要 (REVISION DESCRIPTION)	签名 (SIGNATURE)	日期 (DATE)



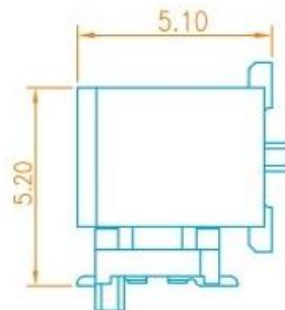
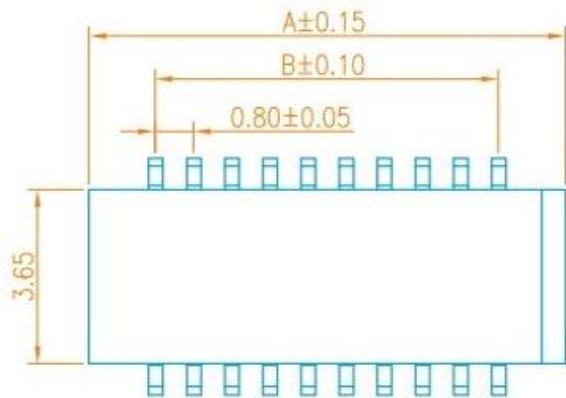

MATING HEIGHT
SCALE:1.25:1

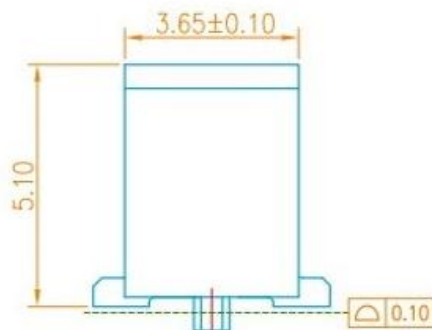
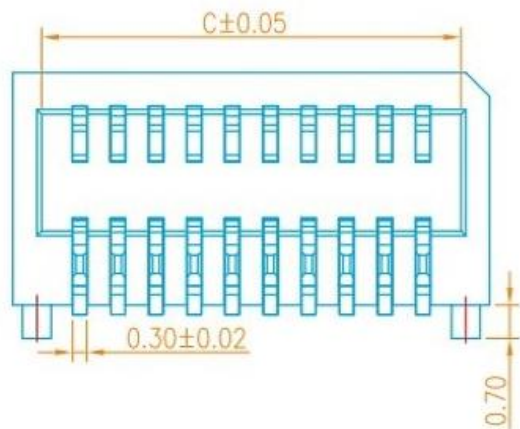

3D VIEW

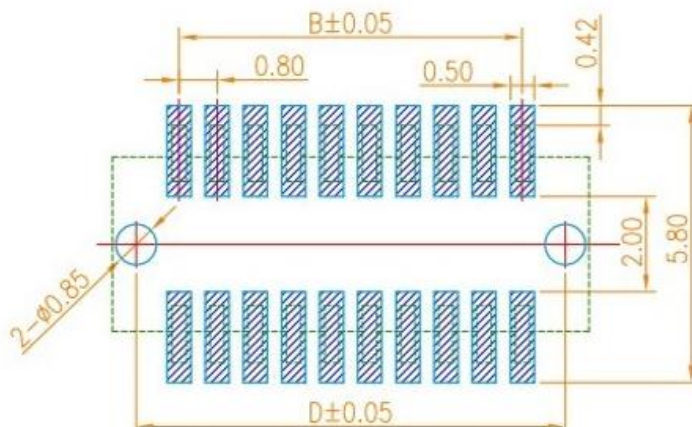
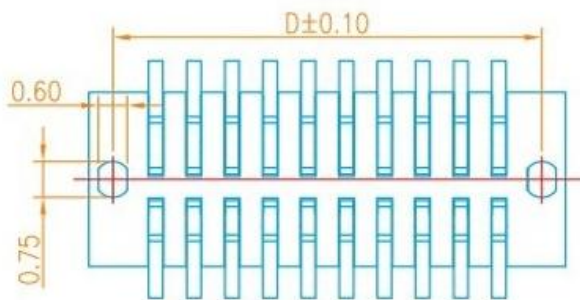

RECOMMENDED PCB PATTERN DIM.

TOLERANCE : ±0.05

NOTES:

- HUOSING: PA9T HIGH-TEMP THERMOPLASTIC UL94V-0 COLOR:CREAM-COLOURED
- TERMINAL:PHOSPHOR BRONZE
PLATING:1μ" GOLD FLASH OVERALL 50~100μ" NICKEL UNDER PLATED.

Ordering information

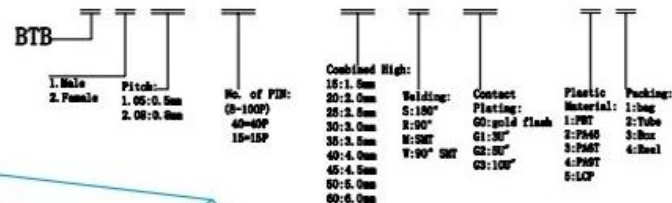

NO. of contacts	Dimensions			
	A.	B.	C.	D.
4	3.60	0.80	2.40	2.60
6	4.40	1.60	3.20	3.40
8	5.20	2.40	4.00	4.20
10	6.00	3.20	4.80	5.00
12	6.80	4.00	5.60	5.80
14	7.60	4.80	6.40	6.60
16	8.40	5.60	7.20	7.40
18	9.20	6.40	8.00	8.20
20	10.00	7.20	8.80	9.00
22	10.80	8.00	9.60	9.80
24	11.60	8.80	10.40	10.60
26	12.40	9.60	11.20	11.40
28	13.20	10.40	12.00	12.20
30	14.00	11.20	12.80	13.00
32	14.80	12.00	13.60	13.80
34	15.60	12.80	14.40	14.60
36	16.40	13.60	15.20	15.40
38	17.20	14.40	16.00	16.20
40	18.00	15.20	16.80	17.00
42	18.80	16.00	17.60	17.80
44	19.60	16.80	18.40	18.60
46	20.40	17.60	19.20	19.40
48	21.20	18.40	20.00	20.20
50	22.00	19.20	20.80	21.00
52	22.80	20.00	21.60	21.80

广东科斯达科技有限公司

一般公差 GENERAL TOLERANCE	Revin 2016.07.05	品名(TITLE): BTB 0.8 2*NP SMT 侧插母座
制图(DWG):	审核(CHECK):	料号(PART NO):
版本(REV): A	核准(APPRO):	比例(SCALE): 1:8
修改摘要 REVISION DESCRIPTION	签名 SIGNATURE	单位(UNITS): mm
日期 DATE	张数(SHEET): 1 OF 1	图幅(SIZE): A4

