

版次 (REV)	变更编号 (ECN NO)	说明 (DESCRIPTION)	日期 (DATE)	核准 (APPD)
X1		初版发行		

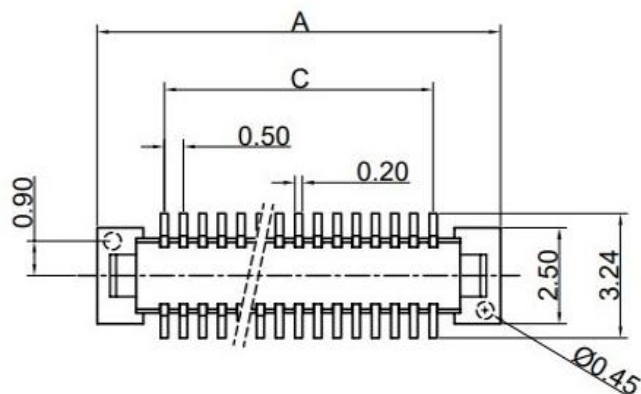

Ordering information

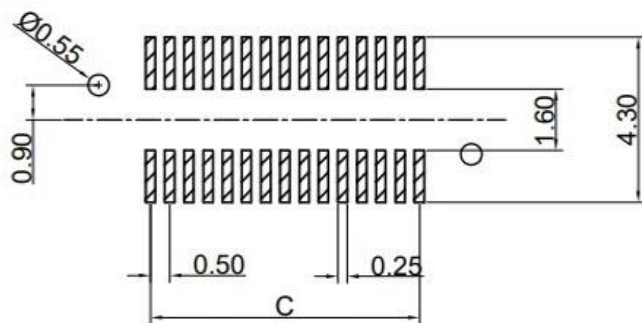
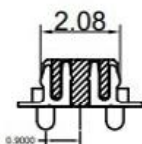
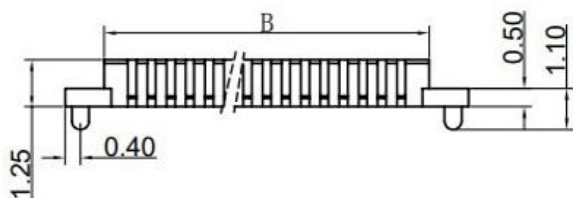
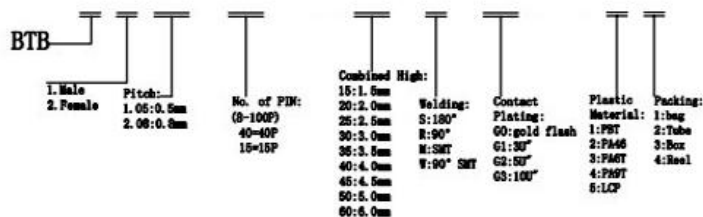

PCB 寸法

Electrical

Voltage:50 V AC(rms)/DC
 Current:0.5A AC(rms)/DC
 Contact Resistance:40 mΩ max(initial)
 Dielectric Withstanding Voltage:200 V AC/rms
 Insulation Resistance:500 MΩ min
 Operating Temp:-25° C~+85° C

P 数	尺 寸			P 数	尺 寸		
	A	B	C		A	B	C
004	5.00	2.90	1.50	033	19.50	17.40	16.00
005	5.50	3.40	2.00	034	20.00	17.90	16.50
006	6.00	3.90	2.50	035	20.50	18.40	17.00
007	6.50	4.40	3.00	036	21.00	18.90	17.50
008	7.00	4.90	3.50	037	21.50	19.40	18.00
009	7.50	5.40	4.00	038	22.00	19.90	18.50
010	8.00	5.90	4.50	039	22.50	20.40	19.00
011	8.50	6.40	5.00	040	23.00	20.90	19.50
012	9.00	6.90	5.50	041	23.50	21.40	20.00
013	9.50	7.40	6.00	042	24.00	21.90	20.50
014	10.00	7.90	6.50	043	24.50	22.40	21.00
015	10.50	8.40	7.00	044	25.00	22.90	21.50
016	11.00	8.90	7.50	045	25.50	23.40	22.00
017	11.50	9.40	8.00	046	26.00	23.90	22.50
018	12.00	9.90	8.50	047	26.50	24.40	23.00
019	12.50	10.40	9.00	048	27.00	24.90	23.50
020	13.00	10.90	9.50	049	27.50	25.40	24.00
021	13.50	11.40	10.00	050	28.00	25.90	24.50
022	14.00	11.90	10.50	051	28.50	26.40	25.00
023	14.50	12.40	11.00	052	29.00	26.90	25.50
024	15.00	12.90	11.50	053	29.50	27.40	26.00
025	15.50	13.40	12.00	054	30.00	27.90	26.50
026	16.00	13.90	12.50	055	30.50	28.40	27.00
027	16.50	14.40	13.00				
028	17.00	14.90	13.50				
029	17.50	15.40	14.00				
030	18.00	15.90	14.50				
031	18.50	16.40	15.00				
032	19.00	16.90	15.50				

使用类别 (EXTEND USE)			品名 (TITLE)	
BTB0.5*1.5-2.5公座带柱			BTB0.5*1.5-2.5公座带柱	
尺寸公差		单位 (UNIT)	客户图面	
DIMENTION		mm	图号 (DWG NO):	
. ±0.30	角度公差	原材料 (MATERIAL)	2001A1	
.0 ±0.20	ANGLES	数量 (QTY)	料号 (P/N):	
.00 ±0.10	. ±3°	表面处理 (FINISHED)	审核 (CHD)	
.000 ±0.05	.0 ±2°		核准 (APPD)	
	.00 ±1°		广东科斯达电子科技有限公司	

版次 (REV)	变更编号 (ECN NO)	说明 (DESCRIPTION)	日期 (DATE)	核准 (APPD)
X1		初版发行		

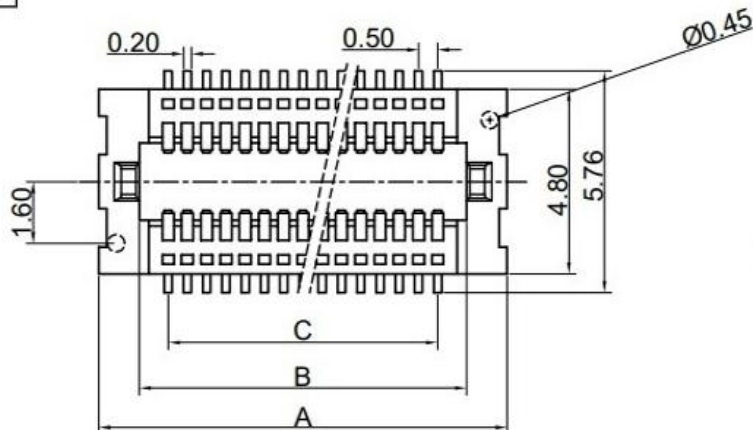

Ordering information

BTB	I. Male	Pitch:	No. of PIN:	Combined High:	Welding:	Contact Plating:	Plastic Material:	Packing:
	2. Female	1.05:0.5mm 2.08:0.8mm	(8-100P) 40=40P 15=15P	15:1.5mm 20:2.0mm 25:2.5mm 30:3.0mm 35:3.5mm 40:4.0mm 45:4.5mm 50:5.0mm 60:6.0mm	S:180° R:90° M:SMT V:90° SMT	G0:gold flash G1:30° G2:50° G3:100°	1:PET 2:PA66 3:PAET 4:PCBT 5:PCP	1:bag 2:Tube 3:Box 4:Reel

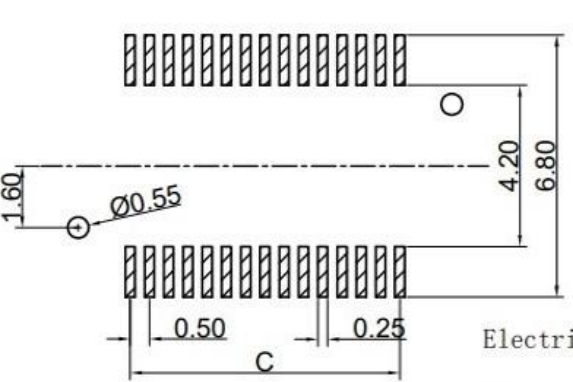
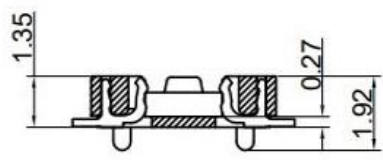
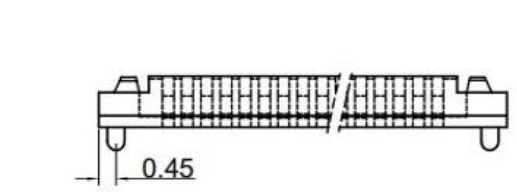

Electrical

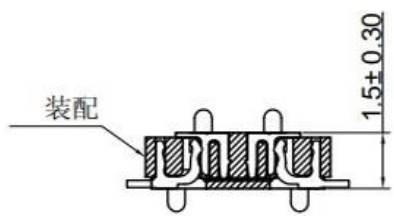

PCB 寸法

Voltage:50 V AC(rms)/DC
 Current:0.5A AC(rms)/DC
 Contact Resistance:40 mΩmax(initial)
 Dielectric Withstanding Voltage:200 V AC/rms
 Insulation Resistance:500 MΩ min
 Operating Temp:-25° C~+85° C

P 数	尺寸			P 数	尺寸		
	A	B	C		A	B	C
004	5.10	3.00	1.50	033	19.60	17.50	16.00
005	5.60	3.50	2.00	034	20.10	18.00	16.50
006	6.10	4.00	2.50	035	20.60	18.50	17.00
007	6.60	4.50	3.00	036	21.10	19.00	17.50
008	7.10	5.00	3.50	037	21.60	19.50	18.00
009	7.60	5.50	4.00	038	22.10	20.00	18.50
010	8.10	6.00	4.50	039	22.60	20.50	19.00
011	8.60	6.50	5.00	040	23.10	21.00	19.50
012	9.10	7.00	5.50	041	23.60	21.50	20.00
013	9.60	7.50	6.00	042	24.10	22.00	20.50
014	10.10	8.00	6.50	043	24.60	22.50	21.00
015	10.60	8.50	7.00	044	25.10	23.00	21.50
016	11.10	9.00	7.50	045	25.60	23.50	22.00
017	11.60	9.50	8.00	046	26.10	24.00	22.50
018	12.10	10.00	8.50	047	26.60	24.50	23.00
019	12.60	10.50	9.00	048	27.10	25.00	23.50
020	13.10	11.00	9.50	049	27.60	25.50	24.00
021	13.60	11.50	10.00	050	28.10	26.00	24.50
022	14.10	12.00	10.50	051	28.60	26.50	25.00
023	14.60	12.50	11.00	052	29.10	27.00	25.50
024	15.10	13.00	11.50	053	29.60	27.50	26.00
025	15.60	13.50	12.00	054	30.10	28.00	26.50
026	16.10	14.00	12.50	055	30.60	28.50	27.00
027	16.60	14.50	13.00				
028	17.10	15.00	13.50				
029	17.60	15.50	14.00				
030	18.10	16.00	14.50				
031	18.60	16.50	15.00				
032	19.10	17.00	15.50				

使用类别 (EXTEND USE)			品名 (TITLE)		<h2>科斯达开关</h2>
BTB0.5*1.5母座有柱			BTB0.5*1.5母座有柱 客户图面		
尺寸公差		单位 (UNIT)	核准 (APPD)		图号 (DWG NO):
DIMENTION		mm	审核 (CHD)		料号 (P/N):
. ±0.30		原材料 (MATERIAL)	绘图 (DRN)		页数 (SHEET)
.0 ±0.20		数量 (QTY)	比例 (SCALE)		1/1
.00 ±0.10		表面处理 (FINISHED)			1:1
.000 ±0.05					