

| | | | |
|------|---------|----------------|----------|
| REV. | ECN.NO. | MODIFY.CONTENT | DATE |
| A | | 初版发行 | 10/16'20 |

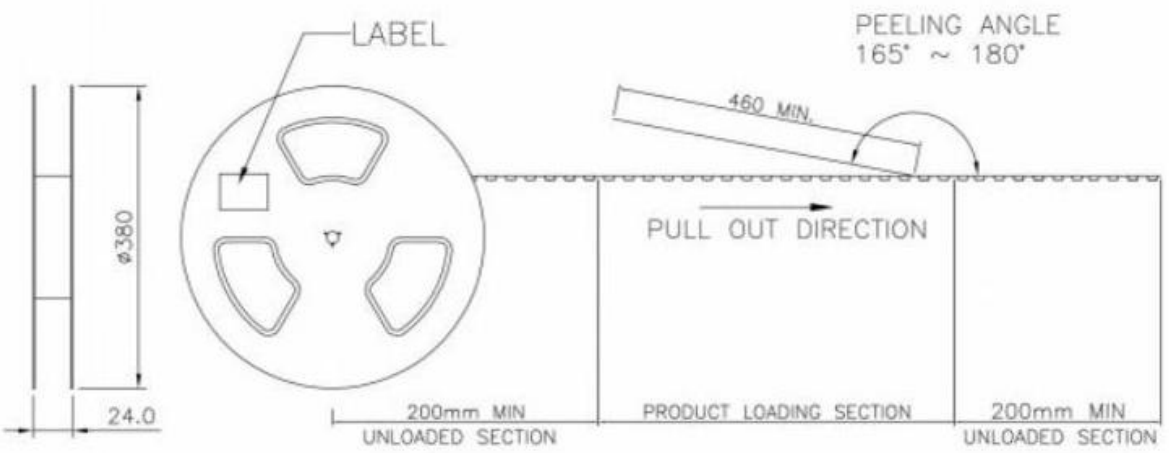

- NOTES :
- MATERIAL :
COVER TAPE : T=0.05
CARRIER TAPE : T=0.35
CARTON: CORRUGATED FIBER
 - DIMENSION :
REEL : 3000PCS/REEL,30000PCS/BOX
SHIPPING BOX: 400X400X300mm
 - QUANTITY : SEE TABLE
 - PEELING RESISTANCE : 30gf~100gf (for 12~56mm)

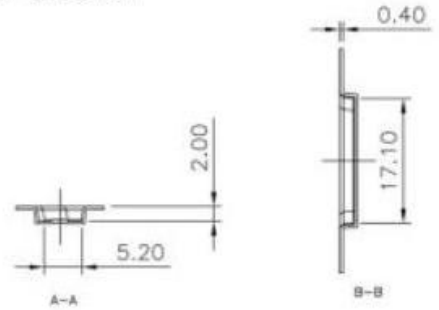
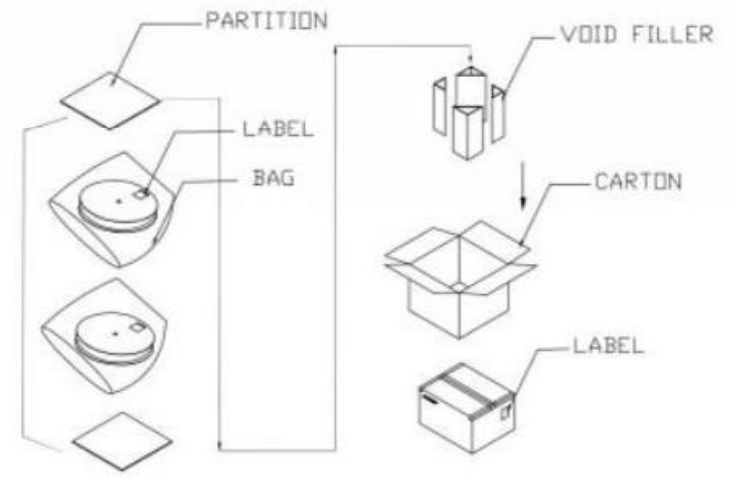
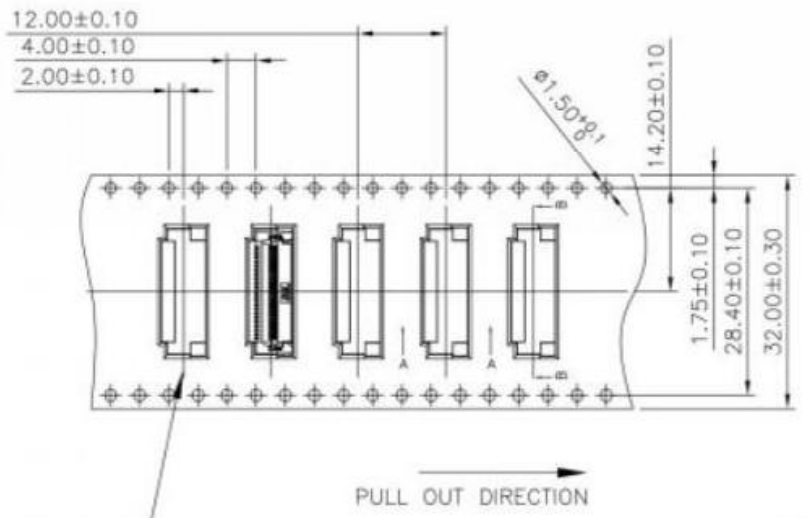

| | | | | | | | |
|-------------------|--------|----------|--------------|----------|-------|---------|-------------------------|
| GENERAL TOLERANCE | | DRAWN | Bin.Liu | 10/15'20 | SCALE | PART NO | |
| X.±0.30 | x.*±3' | CHECKED | Shengjie.Chu | 10/15'20 | N/A | TITLE | 0.5PITCH H=1.5 FPC CONN |
| .X±0.25 | .x*±2' | APPROVED | Cunfa.Lai | 10/15'20 | UNITS | mm | CUSTOMER DRAWING |
| .XX±0.20 | | File NO. | | | | | |
| .XXX±0.10 | | REV. | | | | | |
| SHEET | 2/2 | Q'TY | 1 | REV. | A | | |

广东科斯达开关厂

此文件为双方标准唯一标准
This document is the only standard tested by both parties.

| REV. | ECN.NO. | MODIFY.CONTENT | DATE |
|------|---------|----------------|-----------|
| A | | 初版发行 | 11/06' 19 |

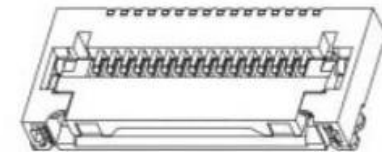
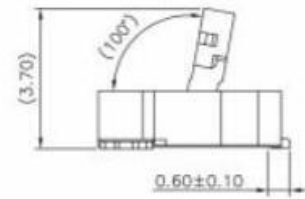
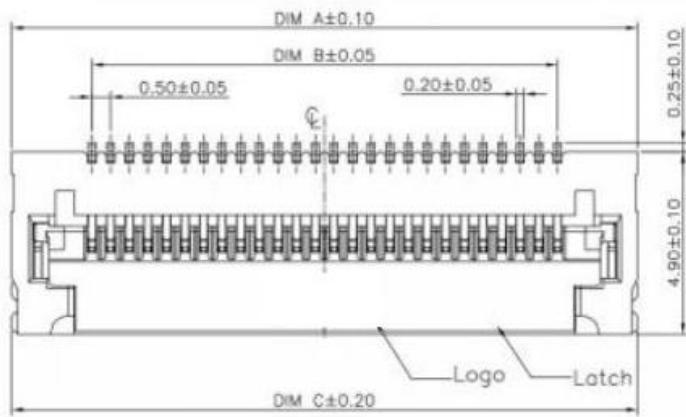

Note:

- Material:
 - Housing: thermoplastic high temp.UL94V-0; Color: natural/black.
 - Latch: thermoplastic high temp.UL94V-0; Color: black.
 - Terminal: copper alloy.
 - Fitting Nail: copper alloy.
- Finish:
 - Terminal Underplating: Gold flash overall.
- Product must comply HF RoHS specification.
- Rating:
 - Operating Voltage: 50V AC/DC.
 - Current Rating: 1.0A AC/DC.
 - Contact Resistance: 30mΩ MAX.
 - Insulation Resistance: 100MΩ MIN AT 500V DC.
 - Withstanding Voltang: 250V AC/Minute.
 - Operating Temperature: -25°C~+85°C.
- Product No:

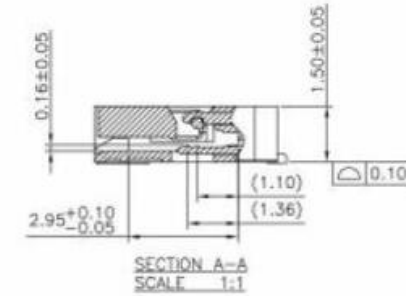
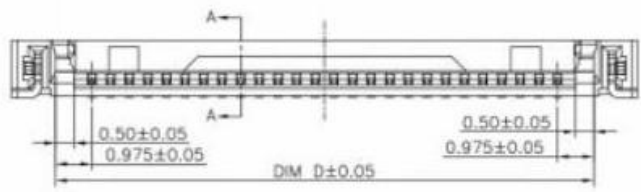

SERIES NUMBER
 PLATING
 F:Gold flash
 U:Gold flash 2u"
 H:Gold flash 3u"
 CKTS
 REMARKS
 HF:Halogen free
 00:RoHS
 PACKING
 1:Tube
 3:Tape&Reel
 COLOUR
 1:Black
 0:White

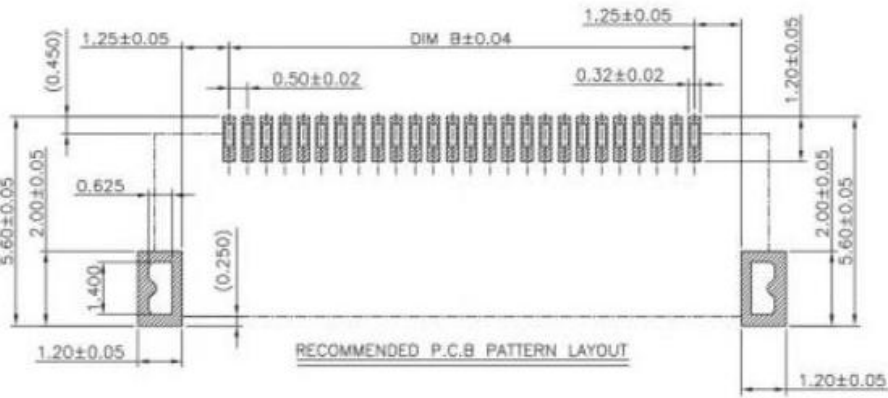
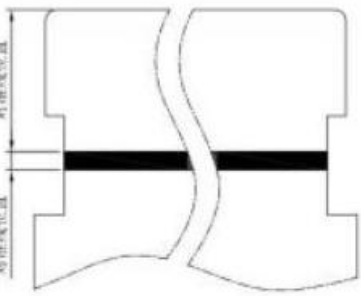
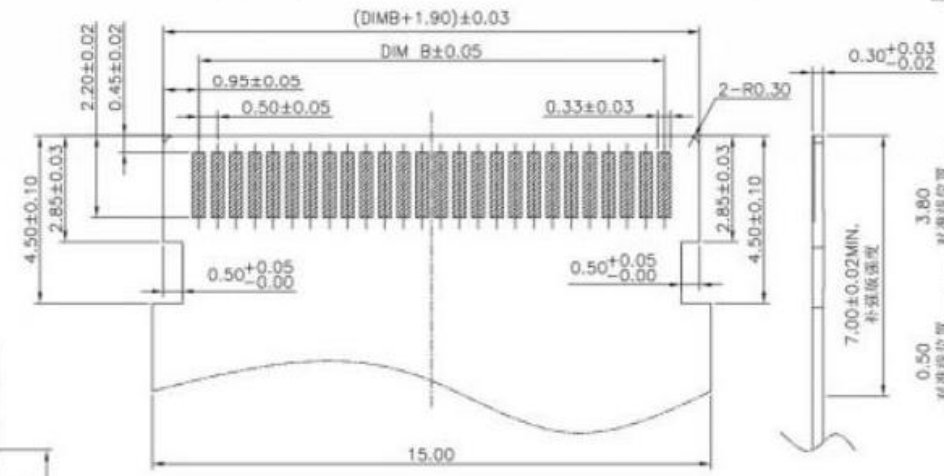
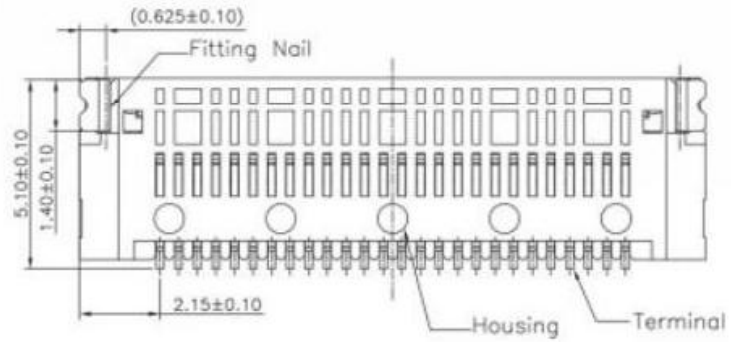

RECOMMENDED FPC/FFC DIMENSION

| GENERAL TOLERANCE | DRAWN | Bin.Liu | 10/15'20 | SCALE | PART NO. |
|-------------------|----------|----------|--------------|----------|----------|
| x.±0.30 | x."±1' | CHECKED | Shengjie.Chu | 10/15'20 | TITLE |
| .x±0.25 | .x'±0.1' | APPROVED | Cunfa.Lai | 10/15'20 | UNITS |
| .xx±0.20 | | | File NO. | | |
| .xxx±0.10 | | | REV. | | |
| SHEET 1/2 | Q'TY 1 | A | | | |

| No. of Contacts | Dimension | | | |
|-----------------|-----------|-------|-------|-------|
| | A | B | C | D |
| 12 | 9.80 | 5.50 | 9.80 | 7.45 |
| 16 | 11.80 | 7.50 | 11.80 | 9.45 |
| 26 | 16.80 | 12.50 | 16.80 | 14.45 |

成品SPEC图

广东科斯达开关厂

注：此文件为双方检验的唯一标准
 This document is the only standard for inspection by both parties.