

REV.	ECN.NO.	MODIFY.CONTENT	DATE
A		初版发行	9/24-20

NOTES:

- MATERIAL:
HOUSING: HIGH-TEM PLASTIC,UL 94-V0,COLOR:NATURAL;
COVER: HIGH-TEM PLASTIC,UL 94-V0,COLOR:BLUE OR BLACK;
CONTACT: COPPER ALLOY;
LEG: COPPER ALLOY;
- PLATING:
CONTACT: GOLD PLATING OVER NICKEL 50u"Min OVERALL.
LEG: TIN PLATED 100~200u" OVER NICKEL 50u"Min OVERALL.
- RATING:
CURRENT RATING: 0.5A AC/DC
VOLTAGE RATING: 50V AC/DC
TEMPERATURE RANGE: -25°C~+85°C;
- PART NO:
1F05023 * ** C 0 *2**

Series NO.

- HF=Halogen Free
- 00=Rohs
- Packing
- 2=Tape&Reel With Mylar
- 3=Tape&Reel
- 0=Color Nature
- C= Bend SMT
- PIN NO.

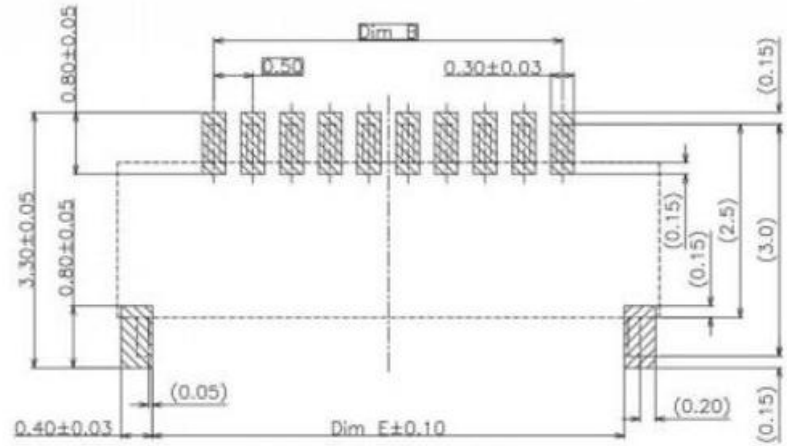
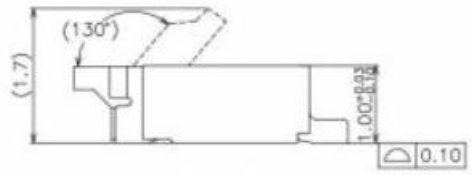
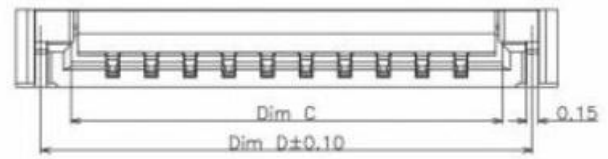
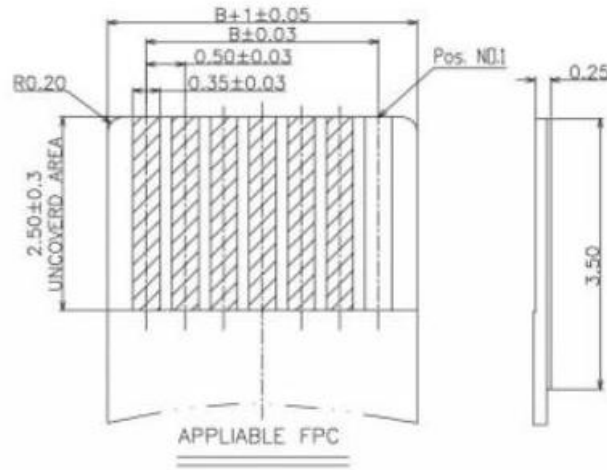
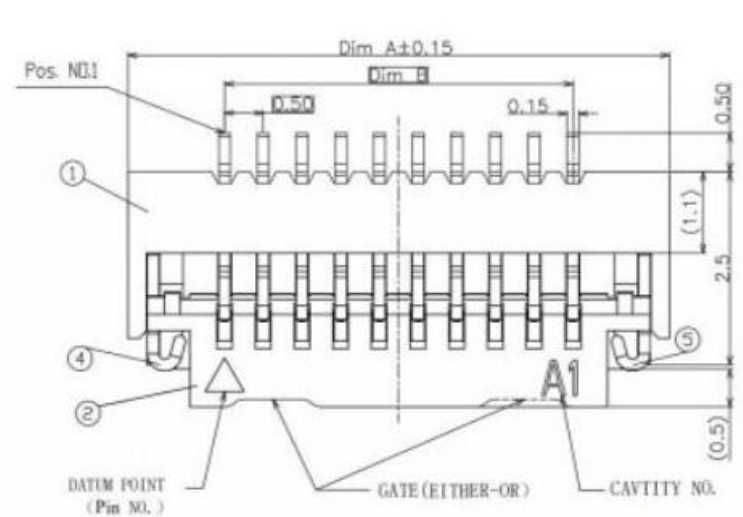

RECOMMENDED PCB LAYOUT

Recommended metal mask thickness: 0.10mm

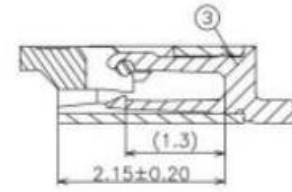

CKT	Dim A	Dim B	Dim C	Dim D	Dim E
4	4.00	1.50	2.57	3.35	3.10
5	4.50	2.00	3.07	3.85	3.60
6	5.00	2.50	3.57	4.35	4.10
7	5.50	3.00	4.07	4.85	4.60
8	6.00	3.50	4.57	5.35	5.10
9	6.50	4.00	5.07	5.85	5.60
10	7.00	4.50	5.57	6.35	6.10
11	7.50	5.00	6.07	6.85	6.60
12	8.00	5.50	6.57	7.35	7.10
13	8.50	6.00	7.07	7.85	7.60
14	9.00	6.50	7.57	8.35	8.10
15	9.50	7.00	8.07	8.85	8.60
16	10.00	7.50	8.57	9.35	9.10
17	10.50	8.00	9.07	9.85	9.60
18	11.00	8.50	9.57	10.35	10.10
19	11.50	9.00	10.07	10.85	10.60
20	12.00	9.50	10.57	11.35	11.10
21	12.50	10.00	11.07	11.85	11.60
22	13.00	10.50	11.57	12.35	12.10
23	13.50	11.00	12.07	12.85	12.60
24	14.00	11.50	12.57	13.35	13.10
25	14.50	12.00	13.07	13.85	13.60
26	15.00	12.50	13.57	14.35	14.10
27	15.50	13.00	14.07	14.85	14.60
28	16.00	13.50	14.57	15.35	15.10
29	16.50	14.00	15.07	15.85	15.60
30	17.00	14.50	15.57	16.35	16.10

GENEAL TOLERANCE		DRAWN	Wilson Sun	2020.09.24	SCALE	PART NO.
X. ±0.30	x.*±3*	CHECKED	Shengjie Chu	2020.09.24	1/1	TITLE
X.X ±0.25	.x *±2*	APPROVED	Cunfa Lai	2020.09.24	UNITS	mm
X.XX ±0.20			File NO.			CUSTOMER DRAWING
X.XXX ±0.10			REV.			
SHEET	1/2	Q'TY	1	A		

广东科斯达开关厂

注: 此文件为双方检验的唯一标准
This document is the only standard tested by both parties.

REV.	ECN.NO.	MODIFY.CONTENT	DATE
A		初版发行	9/24-20

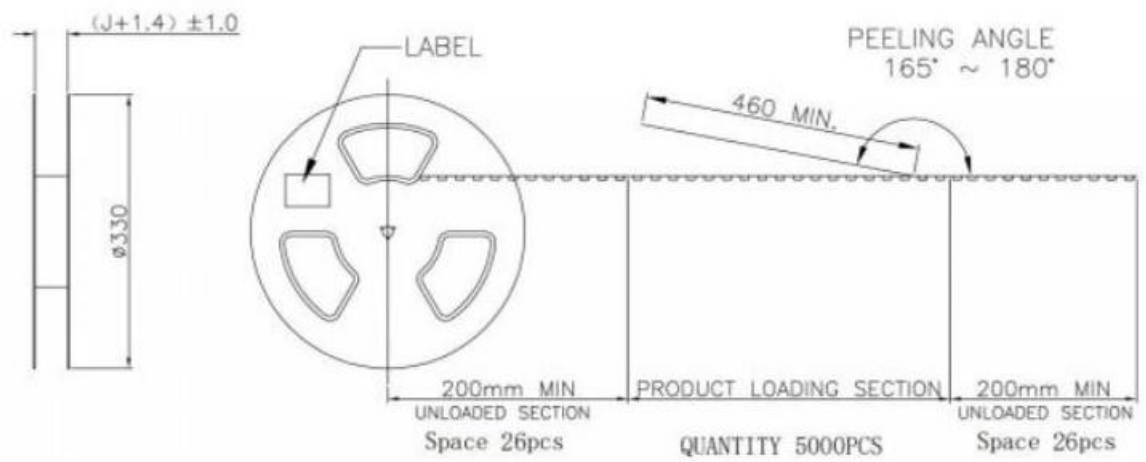

- NOTES:
- MATERIAL:
COVER TAPE:P.S T=0.05mm
CARRIER TAPE:P.S T=0.35mm
CARTON:5ceng BC
 - DIMENSION:
REEL:SEE DRAWING
CARTON SPEC:350X350X300mm
 - PACKING QUANTITY:SEE TABLE
 - PEELING FORCE:10gf~130gf

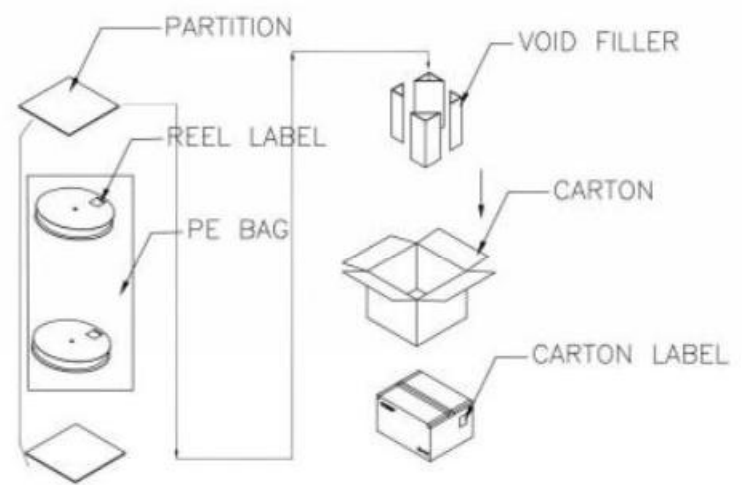
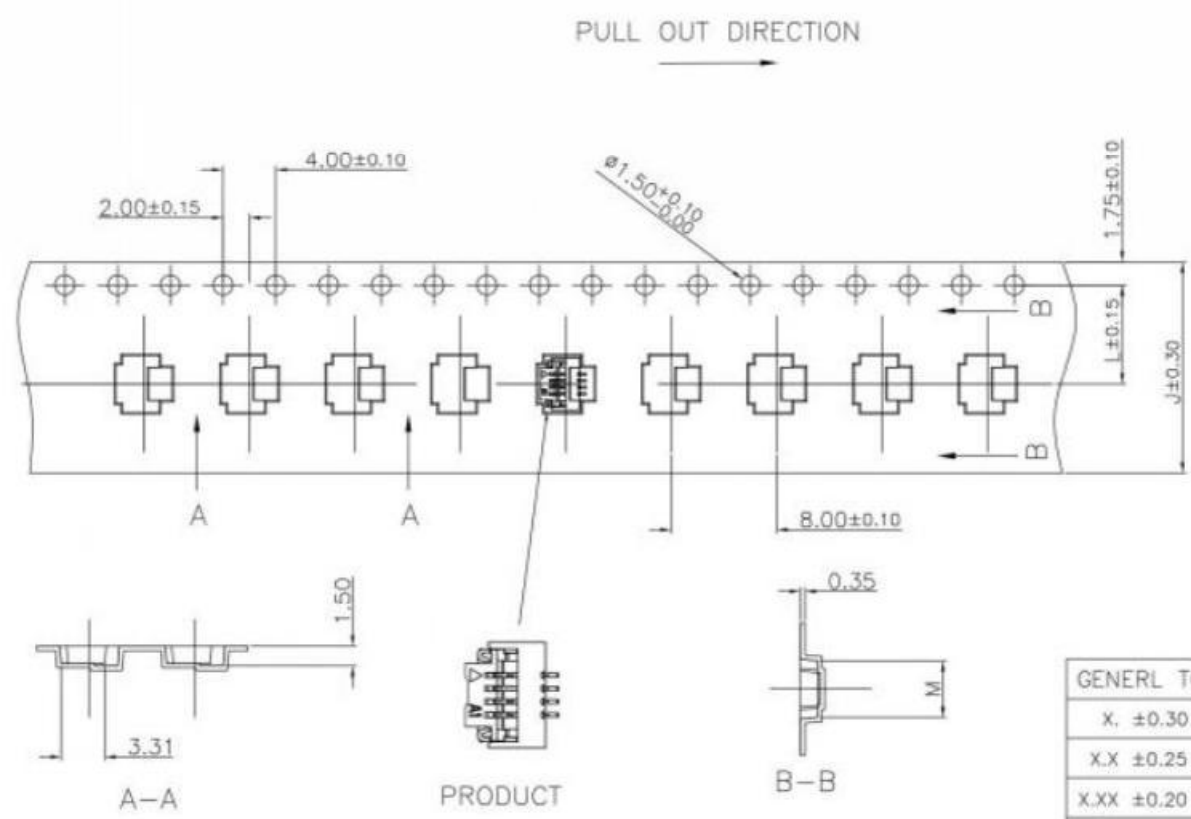

PIN NO.	J	L	M	PCS /REEL	REEL/CARTON	SUM(PCS)
4PIN	16	7.50	4.30	5000	11	55000
6PIN	16	7.50	5.30	5000	11	55000
8PIN	16	7.50	6.30	5000	11	55000

GENERAL TOLERANCE		DRAWN	Wilson Sun	2020.09.24	SCALE	PART NO.
X. ±0.30	x.' ±3'	CHECKED	Shengjie Chu	2020.09.24	1/1	TITLE
X.X ±0.25	.x' ±2'	APPROVED	Cunfa Lai	2020.09.24	UNITS	mm
X.XX ±0.20		File NO.				CUSTOMER DRAWING
X.XXX ±0.10		REV.				
SHEET	2/2	Q'TY	1	A		

广东科斯达开关厂

注：此文件为双方检验的唯一标准
This document is the only standard tested by both parties.