

REV.	ECN.NO.	MODIFY.CONTENT	DATE
A		FIRST VERSION	12/04'19

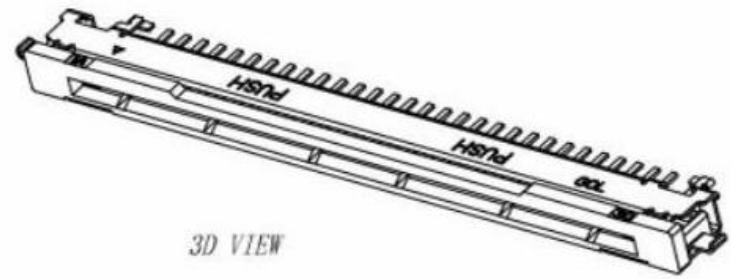

3D VIEW

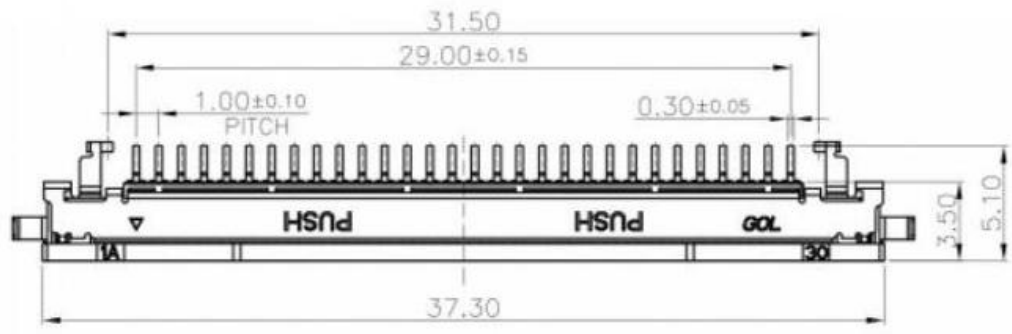
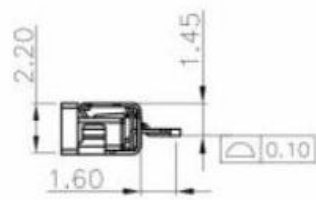
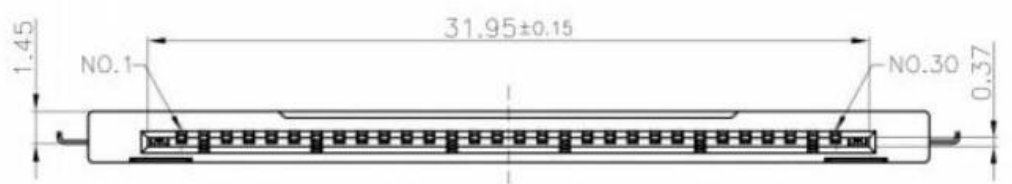

NOTES:
 Insulator: LCP, UL 94V-0
 Shell: STAINLESS STEEL/Tin-Plated
 Terminal: PHOSPHOR COPPER/Au-Plated
 Current Rating: 0.5A AC,DC
 Voltage Rating: 50V AC,DC
 Temperature range: -40°C~+85°C
 Contact resistance: 60mΩ Max
 Insulation resistance: 100MΩ Min
 Withstand voltage: 250V,AC/minute

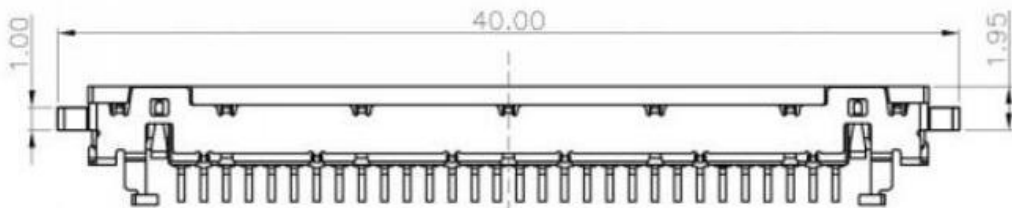

FPC Type
 Serial number
 F:Gold flash
 T:Matte Tin flash
 PIN NO.
 HF:No Halogen
 3:Without mylar & Reel packing
 0:Natural
 1:BLACK

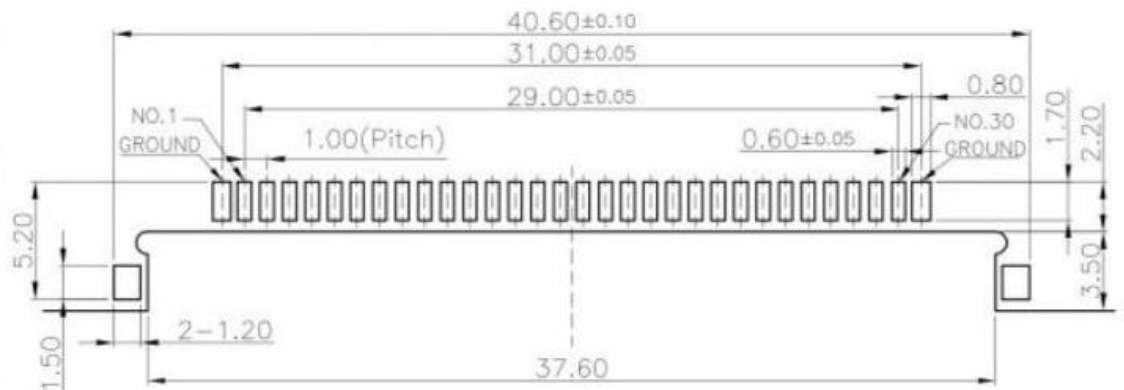

RECOMMEND PCB LAYOUT
 DEFAULT TOL:±0.05

GENERAL TOLERANCE		DRAWN	JON XIA	12/04'19	SCALE	PART NO.
X.±0.30	x.'±3.0'	CHECKED	SHENGJIE CHU	12/04'19	1/1	TITLE
.X±0.25	.x'±2.0'	APPROVED	CUNFA LAI	12/04'19	UNITS	mm
.XX±0.20			File NO.			CUSTOMER DRAWING
.XXX±0.10			REV.			
SHEET	1/3	Q'TY	1	A		

广东科斯达开关厂

This document is the only standard for inspection by both parties.

REV.	ECN.NO.	MODIFY.CONTENT	DATE
A		FIRST VERSION	12/04' 19

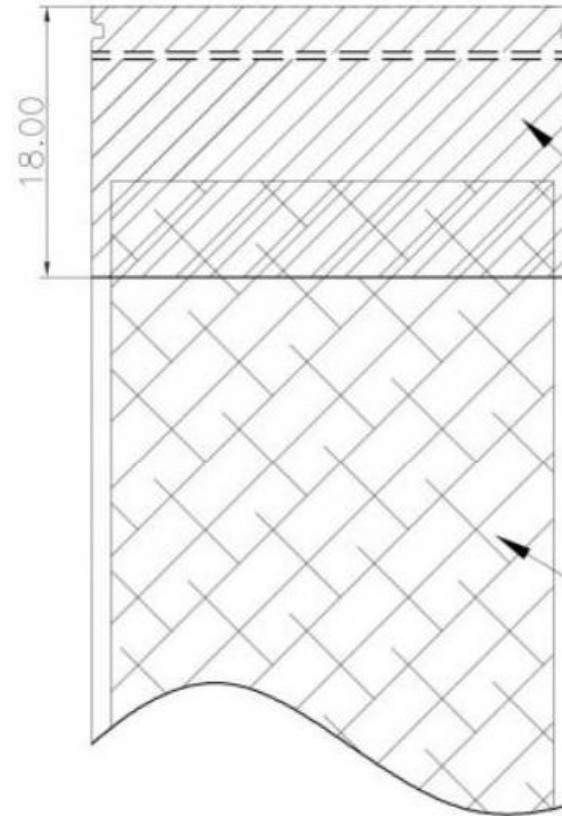
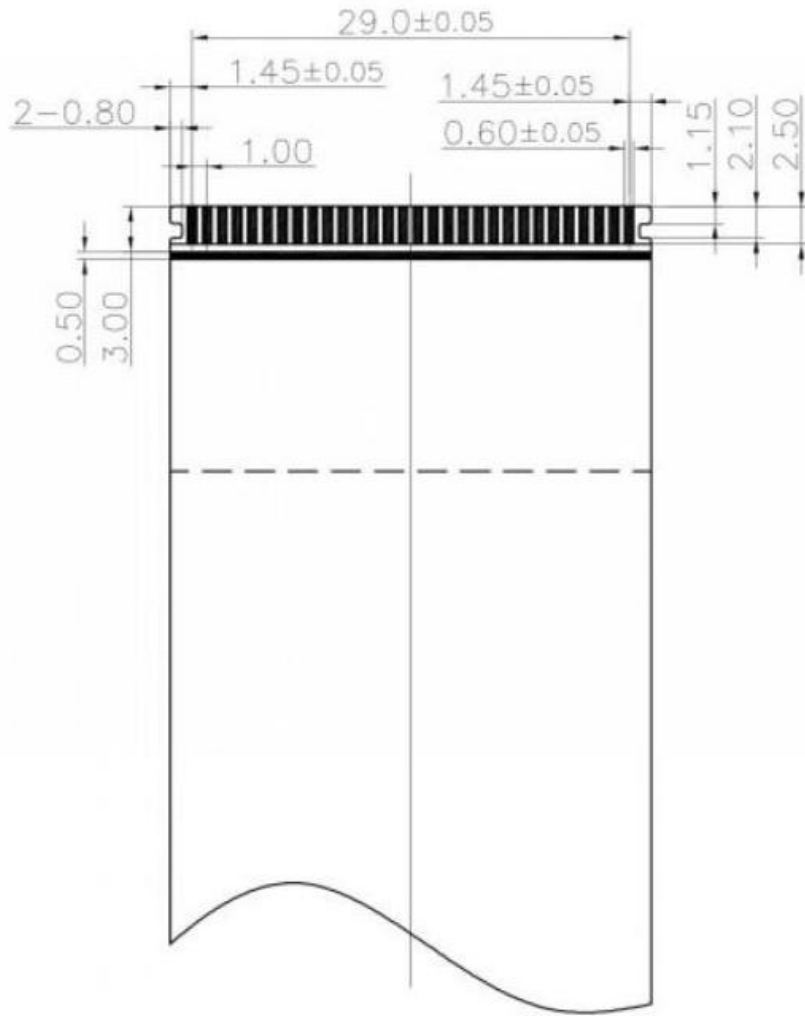

Reinforcing Plate:
Metal Aluminum Foil

Electric Conduction
Aluminum Foil

RECOMMENDED FFC DIMENSION

GENERAL TOLERANCE		DRAWN	JON XIA	12/04'19	SCALE	PART NO.	
X±0.30	x.*±3.0'	CHECKED	SHENGJIE CHU	12/04'19	1/1	TITLE	1.0 Pitch H=L.45 Auto-Lock FFC
.X±0.25	.x'±2.0'	APPROVED	CUNFA LAI	12/04'19	UNITS	mm	CUSTOMER DRAWING
.XX±0.20		File NO.					
.XXX±0.10		REV.					
SHEET	2/3	Q'TY	1	A			
<h1>广东科斯达开关厂</h1>							

REV.	ECN.NO.	MODIFY.CONTENT	DATE
A		FIRST VERSION	12/04'19

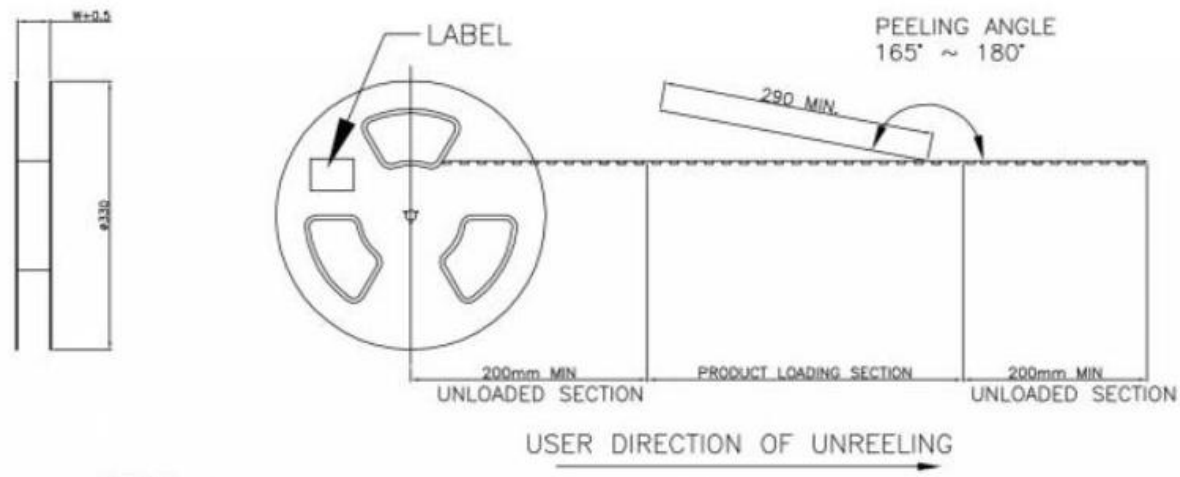

- NOTES :
- MATERIAL :
 COVER TAPE : P.S T=0.05mm
 CARRIER TAPE : P.S T=0.35mm
 CARTON: CORRUGATED FIBER
 - DIMENSION :
 REEL : SEE DRAWING
 SHIPPING BOX: 350X350X300mm
 - QUANTITY : SEE TABLE
 - PEELING RESISTANCE : 10gf~130gf
 - PEELING SPEED : 300mm/MINUTES

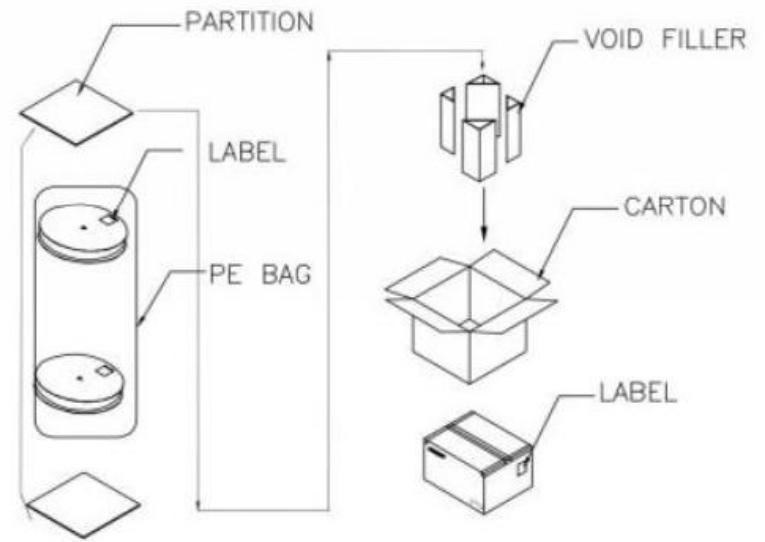
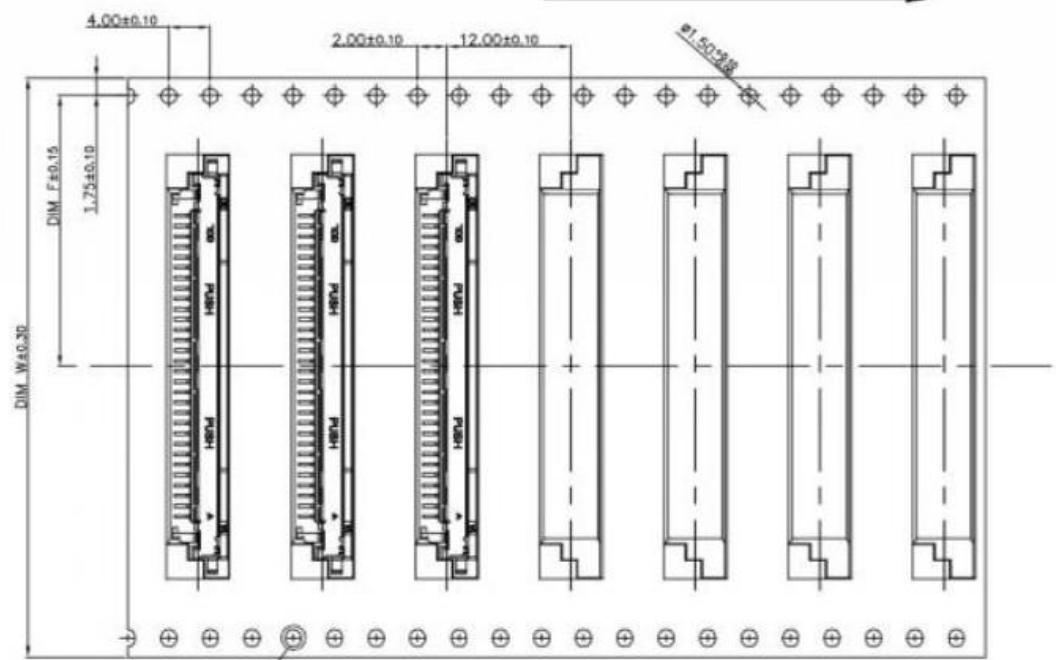
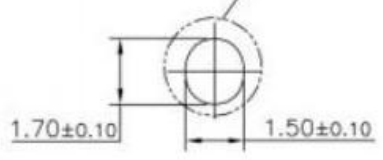

TABLE OF DIM.

POS.	PCS/REEL	BOX/REEL	DIM W	DIM F
30	1500	6000	56	26.20



GENERAL TOLERANCE		DRAWN	JON XIA	12/04'19	SCALE	PART NO.
X.±0.30	x.'±3°	CHECKED	SHENGJIE CHU	12/04'19	1/1	TITLE
.X±0.25	.x'± 2'	APPROVED	CUNFA LAI	12/04'19	UNITS	mm
.XX±0.20		File NO.				CUSTOMER DRAWING
.XXX±0.10		REV.				
SHEET	3/3	QTY	1	A		

广东科斯达开关厂