

RoHS

REV	ECN NO	DESCRIPTION	DATE	NAME
A		NEW		

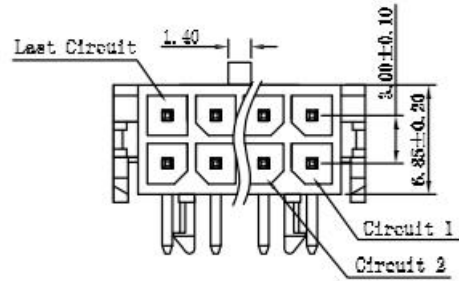

- Note:
- Material
 - Housing: NY66, Color:Black
 - Contact: Brass,Tin.
 - Rating:
 - Operating Voltage: 250V AC/DC.
 - Current Rating: 5A AC/DC.
 - Operating Temperature: -25°C~+85°C.
 - Contact Resistance:30 mΩ max.
 - Insulation Resistance:1000 MΩ min.
 - Dielectric withstanding Voltage: AC 1500V

Pin NO.	Dimensions (mm)	
	A	B
02	---	8.65
04	3.00	9.65
06	6.00	12.65
08	9.00	15.65
10	12.00	18.65
12	15.00	21.65
14	18.00	24.65
16	21.00	27.65
18	24.00	30.65
20	27.00	33.65
22	30.00	36.65
24	33.00	39.65

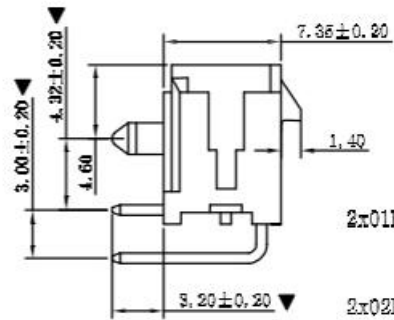
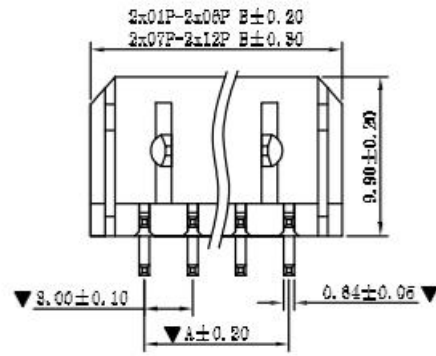

3.Pater Number:

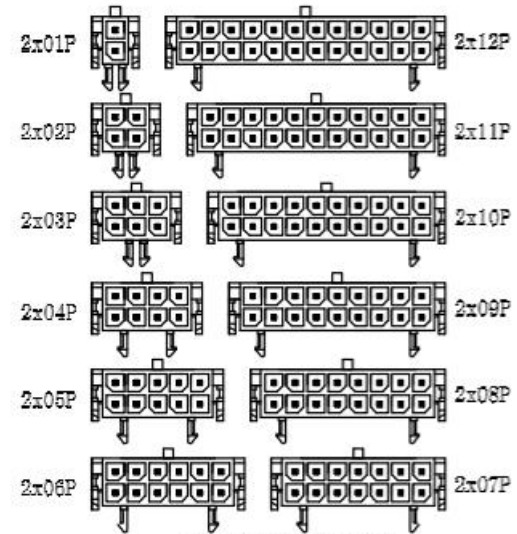

Ordering Information

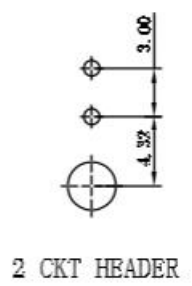
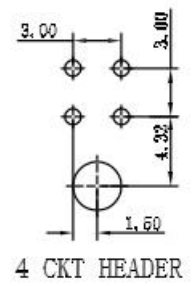
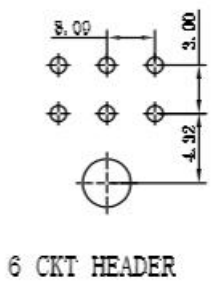
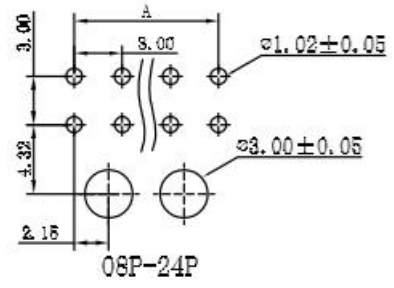
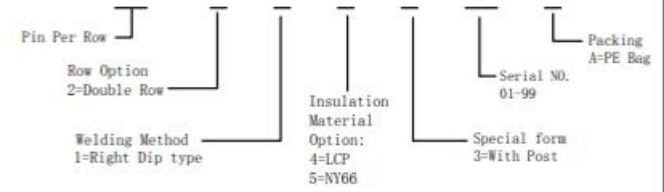

P. C. B. LAYOUT

广东科斯达开关厂

STANDARD TOLERANCE (EXCEPT SPECIFIED)	
LINER	ANGLES
.0 ±0.30	0.° ±3°
.00 ±0.20	.0° ±2°
.000 ±0.10	.00° ±1°

TITLE	PH3.0mm Wafer Double row, Right DIP type	DRAWN BY	WZG	17.03.30
PART NO		CHECKED BY		
DRAWING NO		APPROVED BY		
SCALE	1:1	UNIT	mm	PAGE 1/1
				SIZE A4