

RoHS

REV	CHG NO	DESCRIPTION	DATE	NAME
A		NEW		

NOTE:

Material

Housing: Glass-reinforced Thermoplastic UL 94v-0

Contact: Copper

Contact Plating: Gold or Tin over Nickel

Electrical

Current rating: 2AMP

Dielectric Withstanding voltage: 500vAC

Contact Resistance: 20mΩ Max

Insulation Resistance: 1000MΩ Min

Environmental

Temperature Range: -40°C to +105°C

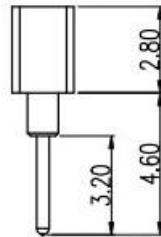
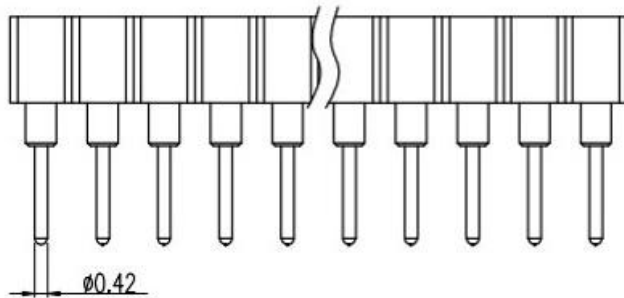
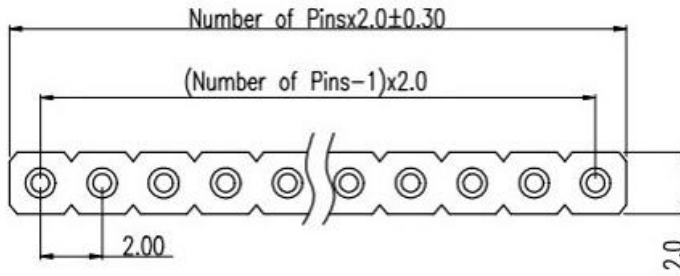

PCB LAYOUT

Ordering Information

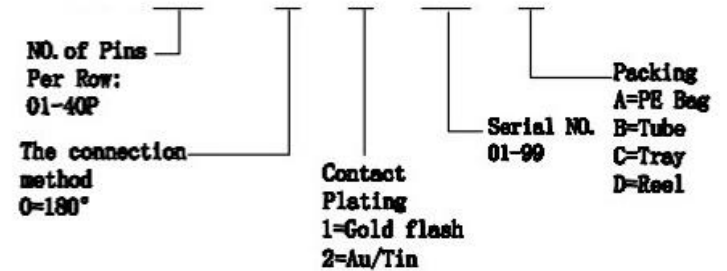

广东科斯达电子科技有限公司

STANDARD TOLERANCE (EXCEPT SPECIFIED)	
LINER	ANGLES
.0 ±0.30	0.° ±3°
.00 ±0.20	.0° ±2°
.000 ±0.10	.00° ±1°

TITLE	FOR THE Hatched Profile Under FIG. 1 Single Pin Straight Type	DRAWN BY	Lujunhui	12.11.05
PART NO		CHECKED BY		
DRAWING NO		APPROVED BY		
SCALE	1:1	UNIT	mm	
PAGE	1/1	SIZE	A4	