

REV	ECN NO	DESCRIPTION	DATE	NAME
A		NEW	5/29-'20	HYJ

RoHS

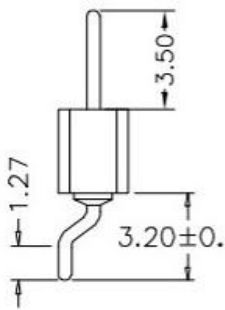
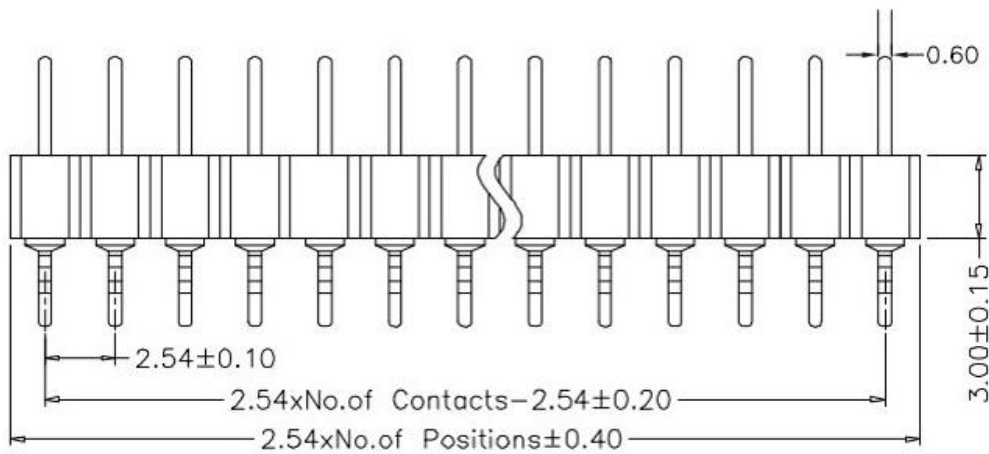

### Technical Data

**Material:**  
 Pin(outer sleeve): Brass,machined CuZn38Pb2  
 Plating(outer sleeve):  
 Tin plated: 2μm/80μ"Ni, 5μm/200μ"Sn  
 Gold Plated: 2μm/80μ"Ni, Full gold  
 Insulator(black): Glass filled thermoplastic polyester  
 UL94V-0

**Electrical:**  
 Current rating: 3Amps/contact max.  
 Contact resistance: £4mW/contact  
 Insulation resistance: <sup>3</sup> 1000MW at V=100V  
 Operating voltage: 60VAC/DC

**Mechanical:**  
 Operating temperatures: Gold Plated: -55°C to +125°C  
 Tin plated: -40°C to +105°C

### Ordering Information

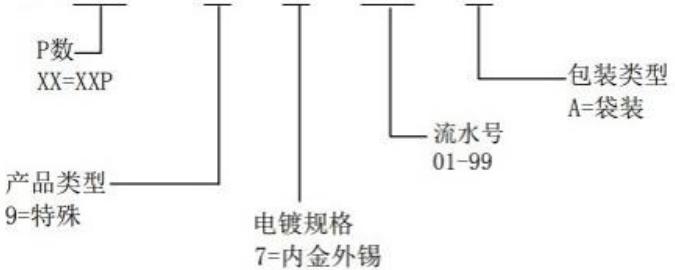

## 广东科斯达电子科技有限公司

STANDARD TOLERANCE (EXCEPT SPECIFIED)	
LINER	ANGLES
.0 ±0.30	0.° ±3°
.00 ±0.20	.0° ±2°
.000 ±0.10	.00° ±1°

TITLE	排针圆孔型-J PH2.54X3.0 1XNP 卧贴 PA3.5 PC3.2	DRAWN BY	HRJ	6/17-'20
PART NO		CHECKED BY		
DRAWING NO		APPROVED BY		
SCALE	1:1	UNIT	mm	
PAGE	1/1	SIZE	A4	