

RoHS

REV	ECN NO	DESCRIPTION	DATE	NAME
A		NEW		

Specifications

1. Current Rating: 1Amps
2. Insulation Resistance: 1000 MΩ min.
3. Dielectric withstanding Voltage: AC 500V
4. Contact Resistance: 20 mΩ max.
5. Operating Temperature: -40°C to +85°C
6. Soldering Temperature: +220°C max, 10s max
7. Contact Material: Brass
8. Insulation Material: PBT 30%, UL94V-0, BLACK
9. Platig: 80-120u" Tin Plating
Nickel Plated With 30-60u"

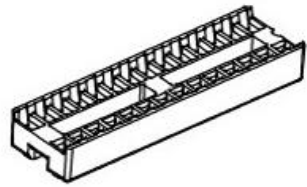

W/ central

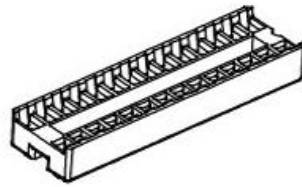

W/O central

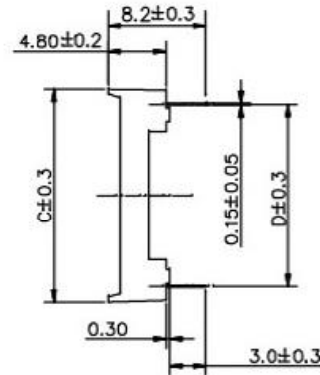
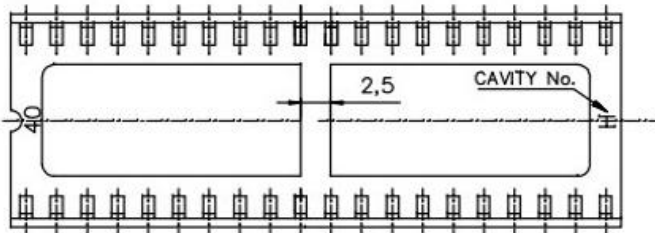

Ordering Information

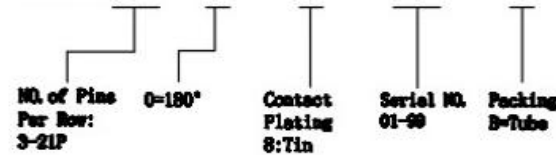

PIN NO.	Dimension			
	A	B	C	D
2X3	7.62	5.08	10.16	7.62
2X4	10.16	7.62	10.16	7.62
2X7	17.78	15.24	10.16	7.62
2X8	20.32	17.78	10.16	7.62
2X9	22.86	20.32	10.16	7.62
2X10	25.40	22.86	10.16	7.62
2X12	30.48	27.94	10.16	7.62
2X12	30.48	27.94	17.78	15.24
2X14	35.56	33.02	10.16	7.62
2X14	35.56	33.02	17.78	15.24
2X16	40.64	38.10	17.78	15.24
2X20	50.80	48.26	17.78	15.24
2X21	53.34	50.80	17.78	15.24

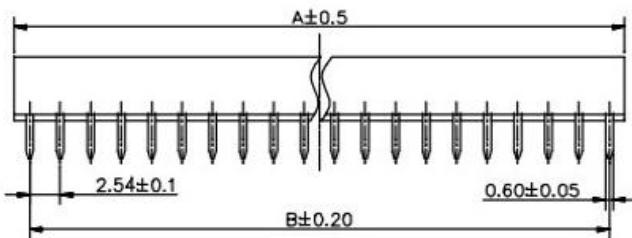

广东科斯达开关厂

STANDARD TOLERANCE (EXCEPT SPECIFIED)	
LINER	ANGLES
.0 ±0.30	0.° ±3°
.00 ±0.25	.0° ±2°
.000 ±0.15	.00° ±1°

TITLE	PER. 84 IC Sockets Stamped Type	DRAWN BY	Lu junhui	18. 10. 23
PART NO		CHECKED BY		
DRAWING NO		APPROVED BY		
SCALE	1:1	UNIT	mm	
PAGE	1/1	SIZE	A4	